

Procedures

NPR 717 Using emergency roadside warning equipment

Description

This document describes the procedure for using emergency roadside warning equipment.

Not what you are looking for? See more [Procedures](#)

Introduction

Emergency roadside warning equipment is used to warn road and pedestrian traffic at Type F level crossings if warning equipment:

- cannot be operated, or
- is to be disconnected.

It consists of:

- yellow covers for flashing lights
- combined RAIL CROSSING and HANDSIGNALLER signs
- PREPARE TO STOP signs
- hand-held STOP signs.

Procedures

NPR 717 Using emergency roadside warning equipment

FIGURE 1: Emergency roadside warning equipment applied to Type F level crossing warning equipment.

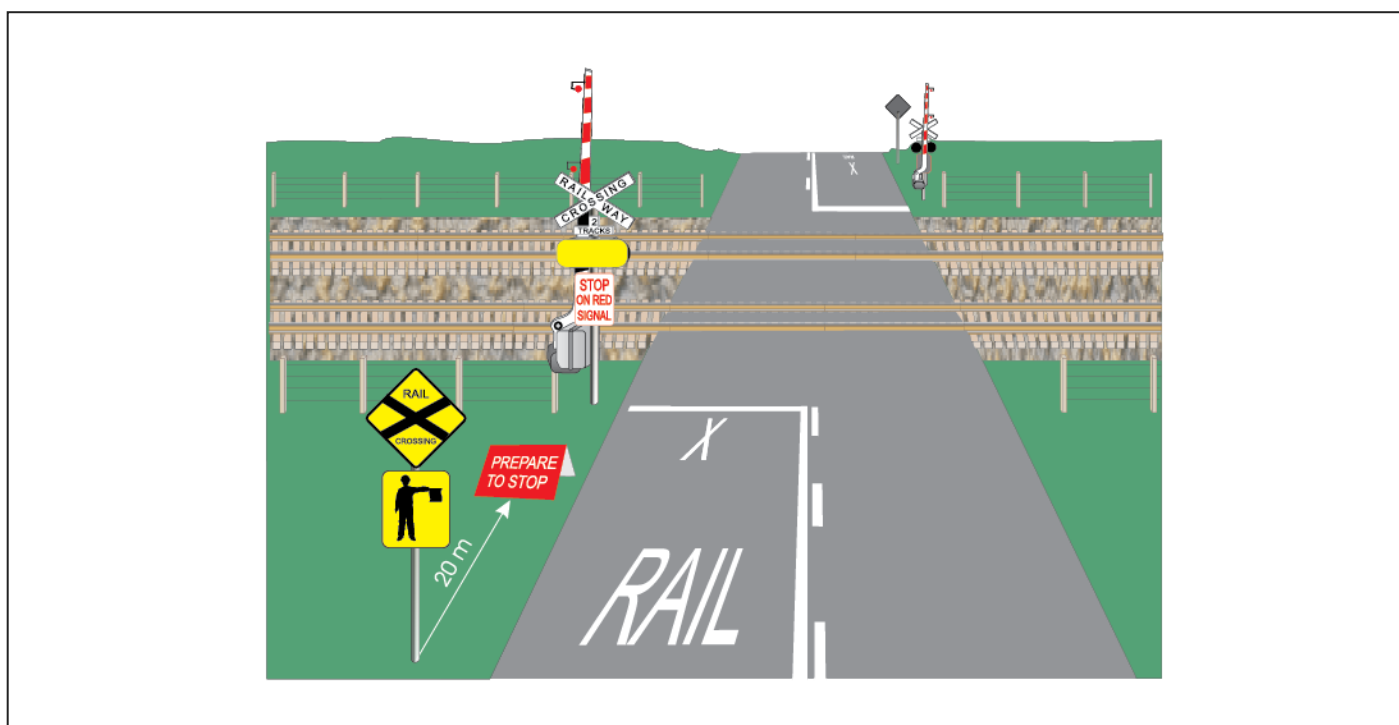

i Note

Where necessary, emergency roadside warning equipment must be used on both sides of the crossing.

Setting up emergency roadside warning equipment

Handsignaller

- 1 If emergency roadside warning equipment is needed, arrange with the Signaller to get the equipment.
- 2 Get the Test and Emergency keys from the controlling location.
- 3 Cover the existing roadside advance warning signs with the combined **RAIL CROSSING** and **HANDSIGNALLER** signs.

Procedures

NPR 717 Using emergency roadside warning equipment

FIGURE 2: Advance warning sign.

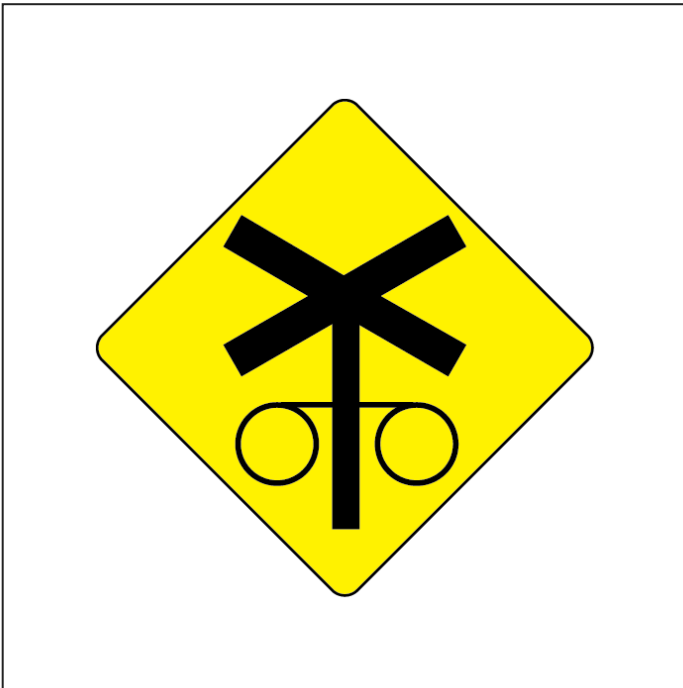
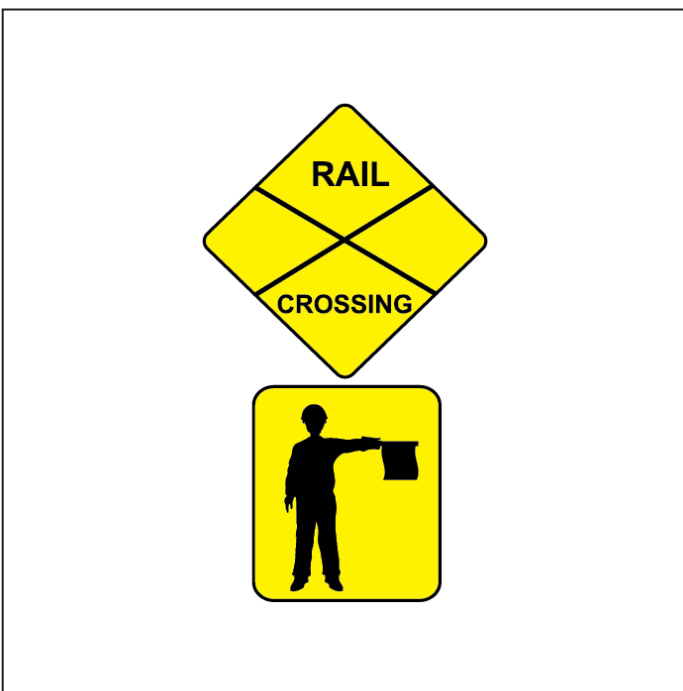

FIGURE 3: Combined RAIL CROSSING and HANDSIGNALLER signs.



- 4 Place a **PREPARE TO STOP** sign 20m closer to the level crossing than the combined **RAIL CROSSING** and **HANDSIGNALLER** signs.

Procedures

NPR 717 Using emergency roadside warning equipment

FIGURE 4: PREPARE TO STOP sign.



- 5 Place yellow covers over the level crossing lights.
- 6 Open the Test and Emergency boxes.
- 7 Insert the keys in the Emergency switches.
- 8 Set Emergency switches to **OFF**.
- 9 Tie a rope to the top cross-brace of each road boom.
- 10 Fully raise the booms by hand, and tie them to the post.

Note

Be careful not to damage the booms.

- 11 Do not tie pedestrian boom arms.

Managing road and pedestrian traffic

Handsignaller

Procedures

NPR 717 Using emergency roadside warning equipment

- 1 Raise pedestrian booms or open gates, as required, to allow pedestrians to cross.
- 2 When rail traffic approaches the level crossing, use the hand-held **STOP** sign to stop road and pedestrian traffic.
- 3 Make sure that pedestrian gates are closed or pedestrian booms are lowered.
- 4 After road and pedestrian traffic has stopped, give a **PROCEED** handsignal to the Driver or Track Vehicle Operator. Make sure that road and pedestrian traffic does not act on your signal.
- 5 When rail traffic has fully cleared the level crossing, and if no other rail traffic is approaching, direct road and pedestrian traffic to proceed.

Returning to normal operation

Signaller

When told by the Maintenance Representative that the warning equipment is certified as working correctly:

- 1 Tell Handsignalers to test the level crossing and return it to normal operation.
- 2 Record the details in permanent form.

Handsignaller

- 3 Make sure that the Test switch is set to **NORMAL**.
- 4 Make sure that all Emergency switches are **ON**.
- 5 Make sure that the Master Emergency Switch (if fitted) is set to **NORMAL**.
- 6 Remove the keys from the Emergency switches.
- 7 Untie ropes from the post.
- 8 Set the Test switch to **TEST**.
- 9 Check that all warning equipment works correctly.
- 10 Untie ropes from the top cross-brace of road booms.
- 11 Return the Test switch to **NORMAL**.
- 12 Check that all warning equipment stops operating.

Procedures

NPR 717 Using emergency roadside warning equipment

- 13 Remove emergency roadside warning equipment.
- 14 Lock the Test and Emergency boxes.
- 15 Tell the Signaller that the level crossing is operational.
- 16 Arrange for emergency roadside warning equipment to be returned.
- 17 Arrange for the Test and Emergency keys to be returned to the controlling location.

Related Documents

NPR 715 Protecting Type F level crossings