

Procedures

# NPR 717 Using emergency roadside warning equipment

## Description

This document describes the procedure for using emergency roadside warning equipment.

Not what you are looking for? See more [Procedures](#)

## Introduction

Emergency roadside warning equipment is used to warn road and pedestrian traffic at Type F level crossings if warning equipment:

- cannot be operated, or
- is to be disconnected.

It consists of:

- yellow covers for flashing lights
- combined RAIL CROSSING and HANDSIGNALLER signs
- PREPARE TO STOP signs
- hand-held STOP signs.

## Procedures

# NPR 717 Using emergency roadside warning equipment

FIGURE 1: Emergency roadside warning equipment applied to Type F level crossing warning equipment.

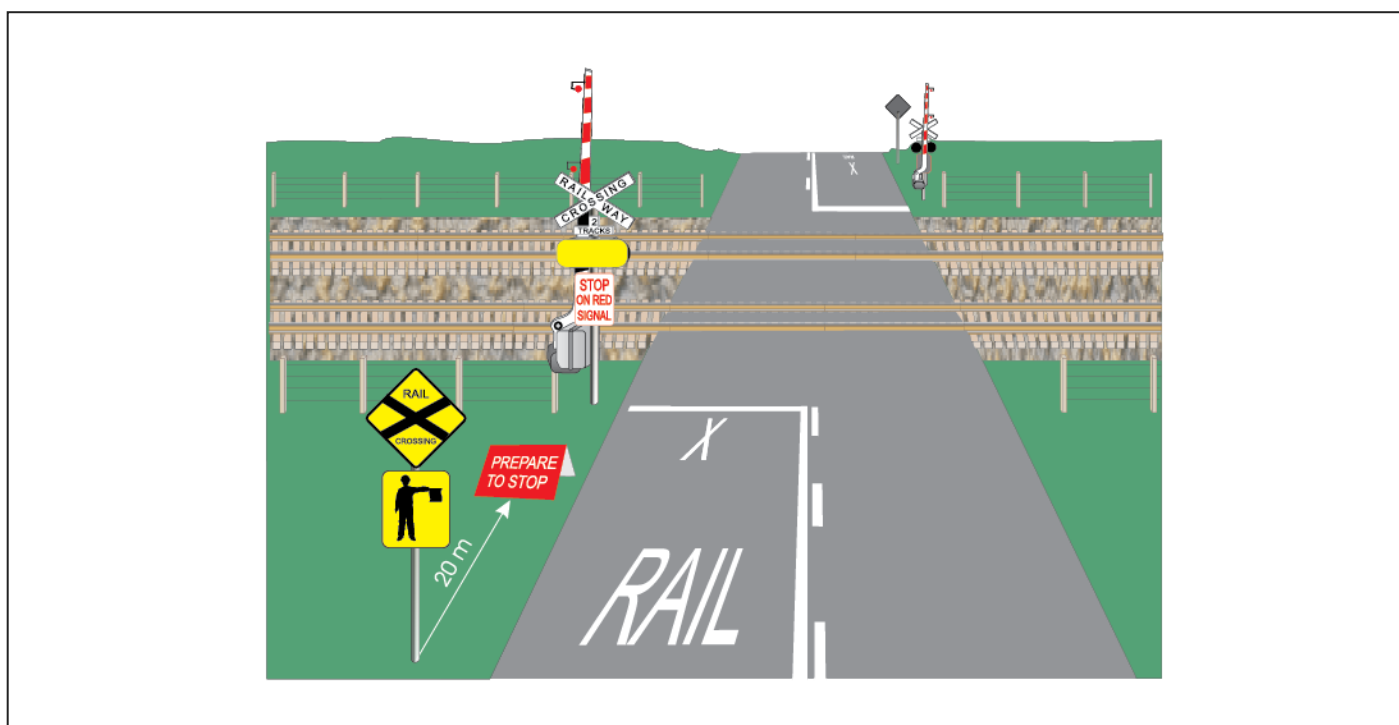

### **i** Note

Where necessary, emergency roadside warning equipment must be used on both sides of the crossing.

## Setting up emergency roadside warning equipment

### Handsignaller

- 1 If emergency roadside warning equipment is needed, arrange with the Signaller to get the equipment.
- 2 Get the Test and Emergency keys from the controlling location.
- 3 Cover the existing roadside advance warning signs with the combined **RAIL CROSSING** and **HANDSIGNALLER** signs.

## Procedures

# NPR 717 Using emergency roadside warning equipment

FIGURE 2: Advance warning sign.

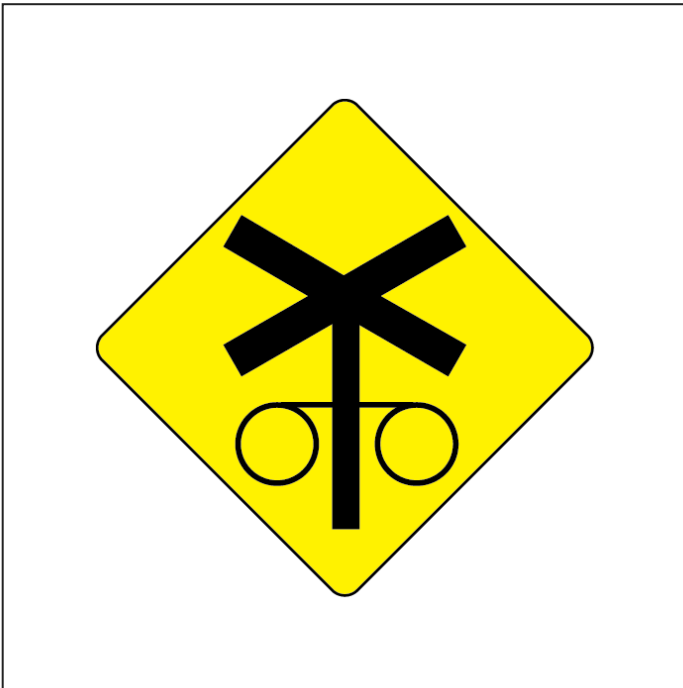
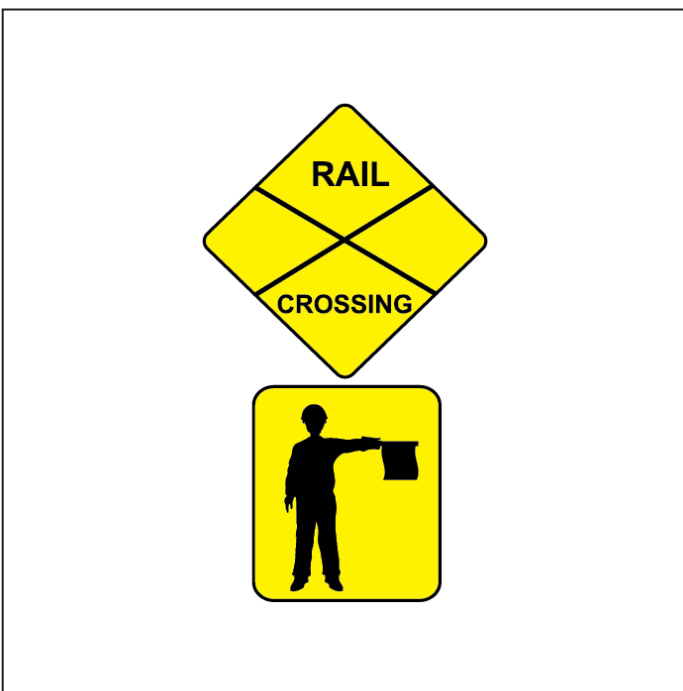

FIGURE 3: Combined RAIL CROSSING and HANDSIGNALLER signs.



- 4 Place a **PREPARE TO STOP** sign 20m closer to the level crossing than the combined **RAIL CROSSING** and **HANDSIGNALLER** signs.

## Procedures

# NPR 717 Using emergency roadside warning equipment

FIGURE 4: PREPARE TO STOP sign.



- 5 Place yellow covers over the level crossing lights.
- 6 Open the Test and Emergency boxes.
- 7 Insert the keys in the Emergency switches.
- 8 Set Emergency switches to **OFF**.
- 9 Tie a rope to the top cross-brace of each road boom.
- 10 Fully raise the booms by hand, and tie them to the post.

### Note

Be careful not to damage the booms.

- 11 Do not tie pedestrian boom arms.

## Managing road and pedestrian traffic

### Handsignaller

## Procedures

# NPR 717 Using emergency roadside warning equipment

- 1 Raise pedestrian booms or open gates, as required, to allow pedestrians to cross.
- 2 When rail traffic approaches the level crossing, use the hand-held **STOP** sign to stop road and pedestrian traffic.
- 3 Make sure that pedestrian gates are closed or pedestrian booms are lowered.
- 4 After road and pedestrian traffic has stopped, give a **PROCEED** handsignal to the Driver or Track Vehicle Operator. Make sure that road and pedestrian traffic does not act on your signal.
- 5 When rail traffic has fully cleared the level crossing, and if no other rail traffic is approaching, direct road and pedestrian traffic to proceed.

## Returning to normal operation

### Signaller

When told by the Maintenance Representative that the warning equipment is certified as working correctly:

- 1 Tell Handsignalers to test the level crossing and return it to normal operation.
- 2 Record the details in permanent form.

### Handsignaller

- 3 Make sure that the Test switch is set to **NORMAL**.
- 4 Make sure that all Emergency switches are **ON**.
- 5 Make sure that the Master Emergency Switch (if fitted) is set to **NORMAL**.
- 6 Remove the keys from the Emergency switches.
- 7 Untie ropes from the post.
- 8 Set the Test switch to **TEST**.
- 9 Check that all warning equipment works correctly.
- 10 Untie ropes from the top cross-brace of road booms.
- 11 Return the Test switch to **NORMAL**.
- 12 Check that all warning equipment stops operating.

## Procedures

# NPR 717 Using emergency roadside warning equipment

- 13 Remove emergency roadside warning equipment.
- 14 Lock the Test and Emergency boxes.
- 15 Tell the Signaller that the level crossing is operational.
- 16 Arrange for emergency roadside warning equipment to be returned.
- 17 Arrange for the Test and Emergency keys to be returned to the controlling location.

## Related Documents

**NPR 715 Protecting Type F level crossings**