

ASB Worksite Protection for Leppington Routine Network Maintenance Activities

WORK DESCRIPTION	Routine network maintenance activities
WPP NUMBER	SW15C 12955
SCOPE	<p>This SWI is applicable for the worksite protection arrangements using ASB concerning routine network maintenance, defect management and repair of assets within the limits specified below and in the attached plan.</p> <p>Work activities include:</p> <ul style="list-style-type: none"> • Routine preventative and corrective work such as inspections and maintenance as appropriate for the type of protection being applied as part of this plan.
AUTHORISATIONS:	Protection Officer: Protection Officer Level 1 or higher
SAFETY CONTROLS: Absolute Signal Blocking (ASB) arrangements:	<p>ASB established to exclude rail traffic on the</p> <ul style="list-style-type: none"> • Up Leppington Main between LE35 Signal and LE56 Signal • Down Leppington Main between LE33 Signal and LE54 Signal <p>For reference only:</p> <p>The assessed ASB protection for the worksite in the down Direction is:</p> <ul style="list-style-type: none"> • LE23 signal and LE31 signal at STOP with blocking facilities applied on the Down Leppington Loop • LE25 signal and LE33 signal at STOP with blocking facilities applied on the Down Leppington Main • LE27 signal and LE35 signal at STOP with blocking facilities applied on the Up Leppington Main • LE29 signal and LE37 signal at STOP with blocking facilities applied on the Up Leppington Loop <p>The assessed ASB protection for the worksite in the up Direction is:</p> <ul style="list-style-type: none"> • LE56 signal and LE62 signal at STOP with blocking facilities applied on the Up Leppington Main • LE54 signal and LE60 signal at STOP with blocking facilities applied on the Down Leppington Main
PRESTART REQUIREMENTS:	<p>Protection Officer assessment checklist must be completed before instructions in this SWI are followed. Tools and equipment required:</p> <ul style="list-style-type: none"> • Protection Officer requires a phone to contact the Signaller
FURTHER INFORMATION:	<p><i>NWT 300 Planning work in the Rail Corridor</i></p> <p><i>NWT 308 Absolute Signal Blocking</i></p> <p><i>NPR 703 Using Absolute Signal Blocking</i></p> <p><i>NGE 200 Walking in the Danger Zone</i></p> <p><i>NLA514 Leppington</i></p>

UNCONTROLLED COPY WHEN PRINTED



Protection Officer assessment checklist		
Protection Officer's name:		Yes (Tick if Yes)
This document has not expired 12 months beyond the issue date.		
On-site safety assessment has been completed and additional hazards and controls recorded on the pre-work briefing (Page 3).		
SWI details and protection arrangements have been reviewed and validated for the assessed worksite location.		
Corridor Safety Number	Protection Officer Signature	Date

 **Warning:** *If an above item does not apply, the Protection Officer must not use this Safe Work Instruction. A new worksite protection plan must be completed in accordance with NRF 014 Worksite Protection Pre-work briefing and NRF 015 Worksite Protection Plan.*

UNCONTROLLED COPY WHEN PRINTED

Worksite Protection Pre-work Briefing

Briefing date:

Protection Officer Details

name signature contact no.

Work location:

Scope of work:

Worksite protection: Refer to Worksite Protection Plan for details

Hazards (e.g. Site specific hazards identified, including physical environment, human errors, plant and equipment)	Controls (to be implemented to eliminate or reduce the risk to the lowest practicable level)	Person responsible for Control
Approaching rail traffic	ASB implemented. Workers to remain within worksite limits.	Protection Officer
Adjacent live lines	Designated work and walk areas as instructed by the Protection Officer. Workers must remain within the ASB nominated worksite location limits whilst work is being performed.	Protection Officer
Access to / Egress from worksite	Protection Officer will assess and instruct when it is safe for workers to use <i>NGE 200 Walking in the Danger Zone</i> to move to and from the worksite or safe place	All
Mobile phone distraction	Mobile phone usage is not allowed in the Danger Zone. Mobile phones may be used only in a safe place after informing the Protection Officer	All

A final site inspection has been conducted immediately before commencing work, and any new hazards and controls have been included.

UNCONTROLLED COPY WHEN PRINTED



Worksite Protection Plan – Absolute Signal Blocking

1. ASB Request – Protection Officer Details

<input type="text" value="name"/>	<input type="text" value="signature"/>	<input type="text" value="contact no."/>
<input type="text" value="RSW or RIW no."/>	<input type="text" value="designation"/>	Planned Duration <input type="text"/>

Type of work:

2. Worksite Location

On the	<input type="text" value="Up Leppington Main"/>	from	<input type="text" value="LE 35 Signal"/>	to	<input type="text" value="LE 56 Signal"/>
	<input type="text" value="Down Leppington Main"/>		<input type="text" value="LE33 Signal"/>		<input type="text" value="LE 54 Signal"/>

3. Protection to be used

Signal(s) at STOP with blocking facilities applied

Protection is required from other Signallers at

4. Assurances

All points of entry into the affected portion of track are protected and blocking facilities applied

The last rail traffic to pass the protection was The last known location of rail traffic is

Confirm that there is no rail traffic between the protection and the worksite

5. Authorisation

Authorised by Signaller

Protection Number Notes

6. Temporarily Suspending ASB					
Provide the name and worksite location	<input type="checkbox"/>	Provide the name and worksite location	<input type="checkbox"/>	Provide the name and worksite location	<input type="checkbox"/>
Workers and equipment are clear of the Danger Zone	<input type="checkbox"/>	Workers and equipment are clear of the Danger Zone	<input type="checkbox"/>	Workers and equipment are clear of the Danger Zone	<input type="checkbox"/>
Provide protection number	<input type="checkbox"/>	Provide protection number	<input type="checkbox"/>	Provide protection number	<input type="checkbox"/>
ASB suspended at	<input type="text" value="hr"/>	ASB suspended at	<input type="text" value="hr"/>	ASB suspended at	<input type="text" value="hr"/>

7. Re-establish ASB assurances					
The worksite location is identical	<input type="checkbox"/>	The worksite location is identical	<input type="checkbox"/>	The worksite location is identical	<input type="checkbox"/>
All points of entry into the affected portion of track are protected and blocking facilities applied	<input type="checkbox"/>	All points of entry into the affected portion of track are protected and blocking facilities applied	<input type="checkbox"/>	All points of entry into the affected portion of track are protected and blocking facilities applied	<input type="checkbox"/>
The last rail traffic to pass the protection was	<input type="text" value="rail traffic ID"/>	The last rail traffic to pass the protection was	<input type="text" value="rail traffic ID"/>	The last rail traffic to pass the protection was	<input type="text" value="rail traffic ID"/>
The last known location of rail traffic is	<input type="text" value="location"/>	The last known location of rail traffic is	<input type="text" value="location"/>	The last known location of rail traffic is	<input type="text" value="location"/>
There is no approaching rail traffic between the protection and the worksite	<input type="checkbox"/>	There is no approaching rail traffic between the protection and the worksite	<input type="checkbox"/>	There is no approaching rail traffic between the protection and the worksite	<input type="checkbox"/>
ASB re-established at	<input type="text" value="hr"/>	ASB re-established at	<input type="text" value="hr"/>	ASB re-established at	<input type="text" value="hr"/>
Protection No	<input type="text"/>	Protection No	<input type="text"/>	Protection No	<input type="text"/>

UNCONTROLLED COPY WHEN PRINTED



8. Ending

Provide name and worksite location Workers and equipment clear of the Danger Zone Provide protection number Ended at hr

6. Temporarily Suspending ASB					
Provide the name and worksite location Workers and equipment are clear of the Danger Zone Provide protection number	<input type="checkbox"/>	Provide the name and worksite location Workers and equipment are clear of the Danger Zone Provide protection number	<input type="checkbox"/>	Provide the name and worksite location Workers and equipment are clear of the Danger Zone Provide protection number	<input type="checkbox"/>
ASB suspended at	<input type="text"/> hr	ASB suspended at	<input type="text"/> hr	ASB suspended at	<input type="text"/> hr
7. Re-establish ASB assurances					
The worksite location is identical All points of entry into the affected portion of track are protected and blocking facilities applied	<input type="checkbox"/>	The worksite location is identical All points of entry into the affected portion of track are protected and blocking facilities applied	<input type="checkbox"/>	The worksite location is identical All points of entry into the affected portion of track are protected and blocking facilities applied	<input type="checkbox"/>
The last rail traffic to pass the protection was	<input type="text"/> rail traffic ID	The last rail traffic to pass the protection was	<input type="text"/> rail traffic ID	The last rail traffic to pass the protection was	<input type="text"/> rail traffic ID
The last known location of rail traffic is	<input type="text"/> Location	The last known location of rail traffic is	<input type="text"/> location	The last known location of rail traffic is	<input type="text"/> location
There is no approaching rail traffic between the protection and the worksite	<input type="checkbox"/>	There is no approaching rail traffic between the protection and the worksite	<input type="checkbox"/>	There is no approaching rail traffic between the protection and the worksite	<input type="checkbox"/>
ASB re-established at	<input type="text"/> hr	ASB re-established at	<input type="text"/> hr	ASB re-established at	<input type="text"/> hr
Protection No	<input type="text"/>	Protection No	<input type="text"/>	Protection No	<input type="text"/>

Notes

6. Temporarily Suspending ASB					
Provide the name and worksite location Workers and equipment are clear of the Danger Zone Provide protection number	<input type="checkbox"/>	Provide the name and worksite location Workers and equipment are clear of the Danger Zone Provide protection number	<input type="checkbox"/>	Provide the name and worksite location Workers and equipment are clear of the Danger Zone Provide protection number	<input type="checkbox"/>
ASB suspended at	<input type="text"/> hr	ASB suspended at	<input type="text"/> hr	ASB suspended at	<input type="text"/> hr
7. Re-establish ASB assurances					
The worksite location is identical All points of entry into the affected portion of track are protected and blocking facilities applied	<input type="checkbox"/>	The worksite location is identical All points of entry into the affected portion of track are protected and blocking facilities applied	<input type="checkbox"/>	The worksite location is identical All points of entry into the affected portion of track are protected and blocking facilities applied	<input type="checkbox"/>
The last rail traffic to pass the protection was	<input type="text"/> rail traffic ID	The last rail traffic to pass the protection was	<input type="text"/> rail traffic ID	The last rail traffic to pass the protection was	<input type="text"/> rail traffic ID
The last known location of rail traffic is	<input type="text"/> location	The last known location of rail traffic is	<input type="text"/> location	The last known location of rail traffic is	<input type="text"/> location
There is no approaching rail traffic between the protection and the worksite	<input type="checkbox"/>	There is no approaching rail traffic between the protection and the worksite	<input type="checkbox"/>	There is no approaching rail traffic between the protection and the worksite	<input type="checkbox"/>
ASB re-established at	<input type="text"/> Hr	ASB re-established at	<input type="text"/> hr	ASB re-established at	<input type="text"/> hr
Protection No	<input type="text"/>	Protection No	<input type="text"/>	Protection No	<input type="text"/>

8. Ending

Provide name and worksite location Workers and equipment clear of the Danger Zone Provide protection number Ended at hr

UNCONTROLLED COPY WHEN PRINTED



INSTRUCTIONS:	<ol style="list-style-type: none"> 1. Workers enter the rail corridor via access gate as per shown by Image 1 M28 52.341 U or Image 2 M28 51.383U 2. Protection Officer briefs workers about the worksite protection arrangements and the nominated safe place. 3. Protection Officer contacts the Signaller at Glenfield Panel to request ASB. 4. After ASB has been authorised. start work within the limits of the nominated worksite location. 5. Protection Officer instruct workers to move and remain in the safe place when ASB suspension is required. 6. Worker/s immediately move to safe place when warned 7. Repeat steps 4 – 6 until work is completed. 8. Protection Officer contacts the Signaller at Glenfield Panel to end ASB. 9. All workers egress the rail corridor via nearest Access gate
----------------------	--

ADDITIONAL DETAILS	<p>Suspending ASB</p> <p>If the ASB is required to be suspended, the Protection Officer must make sure all workers and equipment are clear of the Danger Zone and are in a safe place before suspending the ASB.</p>
---------------------------	---

IMAGES:	 <p>Image 1: Access gate NO: M28 52.341 U 33 Eastwood RD</p>	 <p>Image 2: access gate NO: M28 51.383U Leppington station car park</p>
----------------	--	---

UNCONTROLLED COPY WHEN PRINTED



Image 3: Down cess near LE 31 signal towards Leppington Station.



Image 4: Down cess near LE 31 signal towards Leppington Yard.



Image 5: View from countryside of Leppington station towards Leppington yard



Image 6: View from Leppington yard towards Leppington station

UNCONTROLLED COPY WHEN PRINTED

Diagram

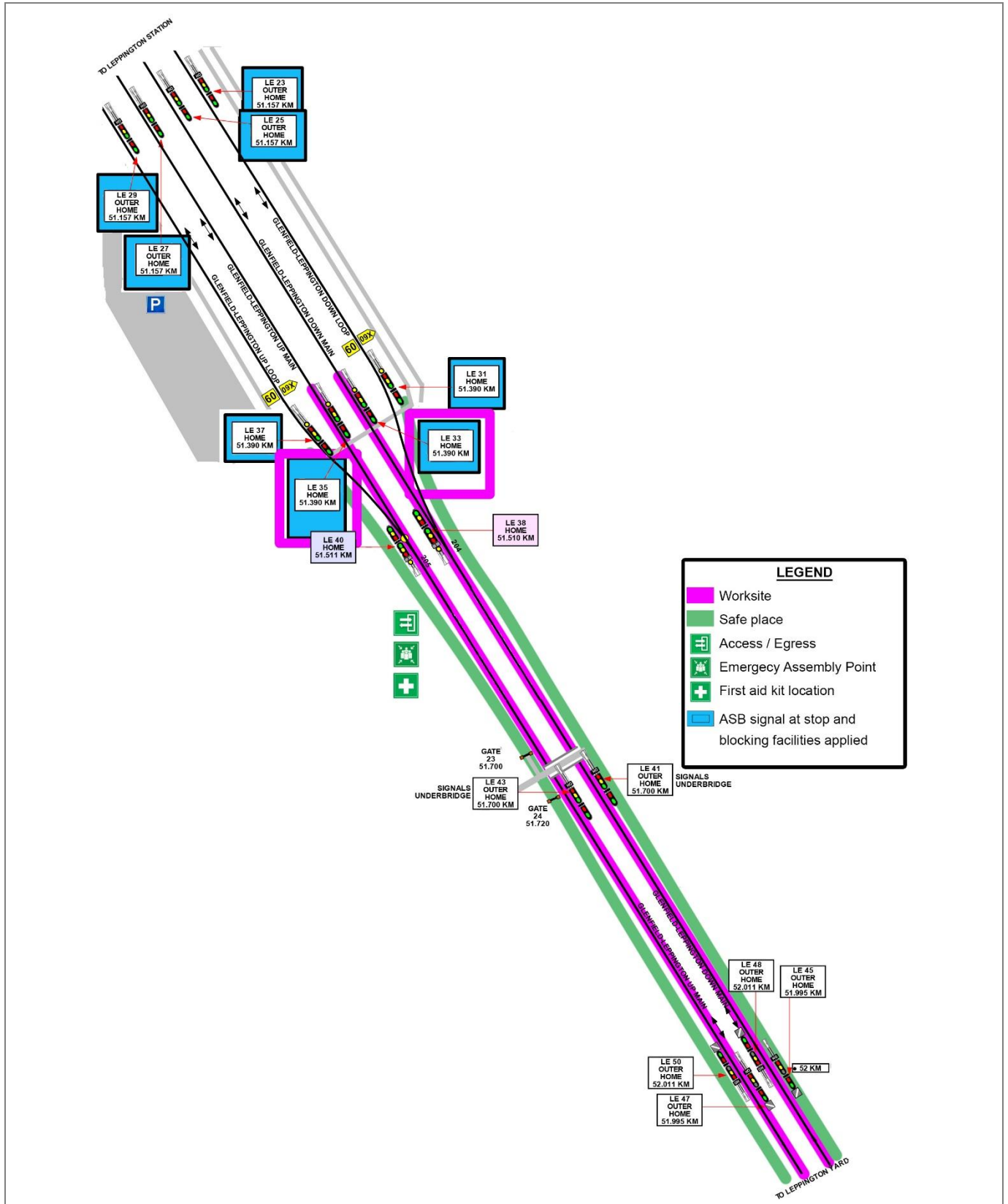

UNCONTROLLED COPY WHEN PRINTED

LEGEND

- Worksite
- Safe place
- + Access / Egress
- + Emergency Assembly Point
- + First aid kit location
- ASB signal at stop and blocking facilities applied

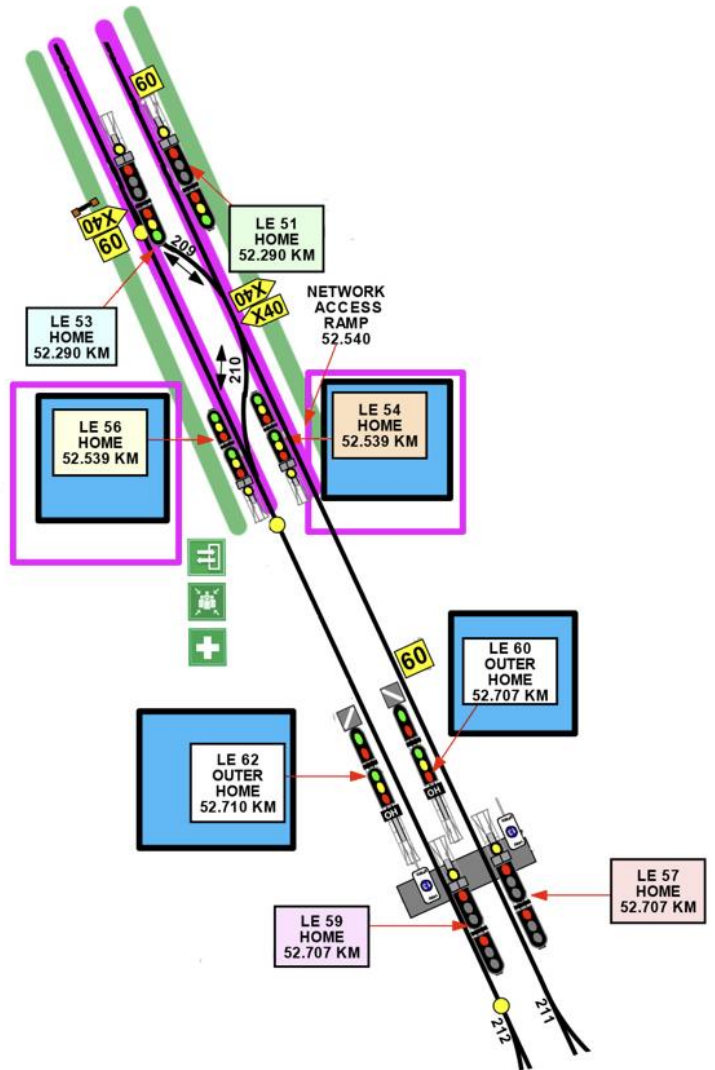

UNCONTROLLED COPY WHEN PRINTED

