

DRIVERS ROUTE KNOWLEDGE DIAGRAMS

BANKSTOWN LINE

BANKSTOWN

YAGOONA

BIRRONG

**THE BANKSTOWN LINE IS
TEMPORARILY CLOSED.**

**SYDENHAM TO BANKSTOWN WILL
FORM PART OF THE SYDNEY METRO
UPON REOPENING.**

Effective Date: June 2025

Version: 4.62

Explanatory Notes:

Navigate to your area of interest via the station index or by using links created in Adobe bookmarks.

This document is approved for **route knowledge only**.

Do not use these diagrams for any safety related purpose without validating the information against a controlled source or in the field.

Information in these diagrams is uncontrolled.

Please report any updates to
gis.support@transport.nsw.gov.au



Copyright: Sydney Trains

Ownership: Location Services

Location: CM Record No.D2015/586

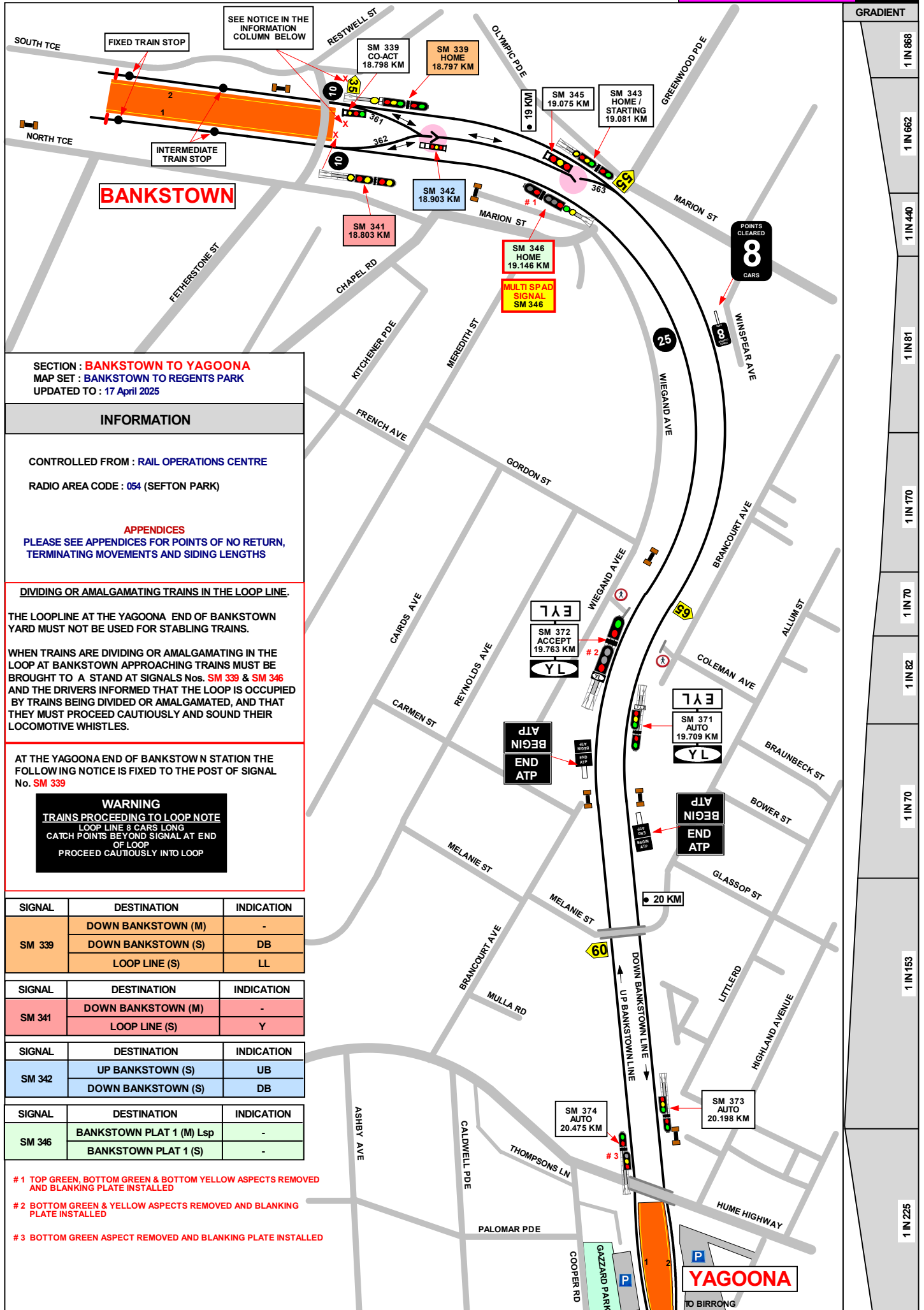

SECTION : **YAGOONA TO BIRRONG**
 MAP SET : **BANKSTOWN TO REGENTS PARK**
 UPDATED TO : 17 April 2025

INFORMATION

CONTROLLED FROM : **RAIL OPERATIONS CENTRE**

RADIO AREA CODE : **054 (SEFTON PARK)**

GRADIENT

1 IN 225

LEVEL

1 IN 79

1 IN 72

1 IN 1320

1 IN 70

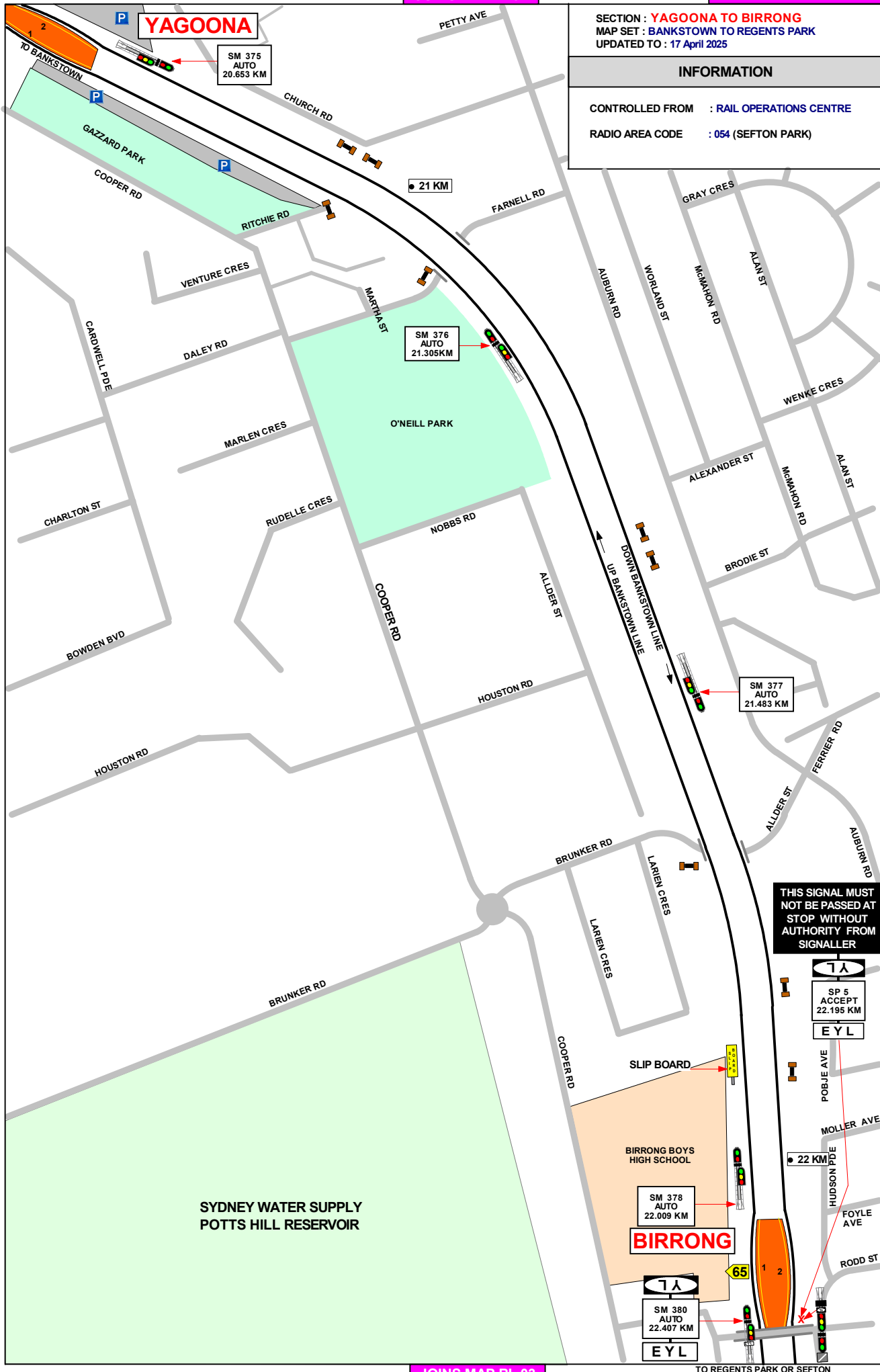

FREIGHT LINE CONTROLLED FROM
JUNEE NCCS " SYDNEY 2" BOARD
PHONE No. 02 6924 9804
EMERGENCY PHONE No. 02 6924 9863

RADIO AREA CODE :
NATIONAL TRAIN COMMUNICATION SYSTEM (NTCS)

SUBURBAN LINES
CONTROLLED FROM : RAIL OPERATIONS CENTRE

RADIO AREA CODE : 054 (SEFTON PARK)

**PLEASE SEE APPENDICES FOR POINTS OF NO RETURN,
TERMINATING MOVEMENTS AND SIDING LENGTHS**

