

This is an uncontrolled copy. Before use, make sure that this is the current version by visiting [www.railsafe.org.au/safe-tracks](http://www.railsafe.org.au/safe-tracks)

## Managing worksites within a Local Possession Authority

**This information has been prepared to inform Qualified Workers about the requirements of managing worksites within a Local Possession Authority (LPA).**

Worksites within an LPA must be managed in accordance with NWT 302 Local Possession Authority and NPR 700 Using a Local Possession Authority.

### Protecting worksites

Unless otherwise specified in NWT 302 Local Possession Authority, worksites must have three railway track signals, and a worksite protection marker placed between 500m and 1000m from each end.

Worksite protection markers must include the contact details of the Protection Officer.

### Worksites within 500m of an LPA limit

If there is a worksite within 500m of an LPA limit, it must be protected by:

- the protection at the LPA limit, and
- a worksite protection marker placed adjacent to the possession limit marker.

Where a fixed signal can provide access to an LPA limit, a worksite may be established within 500m of the limit only if:

- Lookout Working is established in accordance with NWT 310 Lookout Working, or
- a set of points has been clipped and locked to prevent access to the LPA limit, or
- a TWA or TOA adjoining the LPA limits has been authorised to prevent rail traffic from approaching the LPA limit for the period of the work.

Worksites with associated rail traffic must not be established within 500m of an LPA limit unless a TOA adjoining the LPA limit has been authorised.

### Multiple worksites

Worksites less than 500m apart must be protected and managed as a single worksite or as a coordinated worksite.

If worksites are between 500m and 1000m apart, three railway track signals must be placed midway between (refer to figure 1):

- the worksites, or
- the worksite and the coordinated worksite.

A worksite protection marker must be placed next to the middle railway track signal.

### Coordinated worksite

Worksites less than 500m apart that cannot be managed as a single worksite, must be protected and managed as a coordinated worksite.

A coordinated worksite must have:

- approved worksite delineation markers placed midway between worksites, and
- railway track signals and worksite protection markers placed between 500m and 1000m from the outermost worksites.

If coordinated worksites are between 500m and 1000m apart (refer to figure 2):

- three railway track signals must be placed midway between the coordinated worksites, and
- a worksite protection marker must be placed next to the middle railway track signal.

Worksite delineation markers must include the contact details of the Protection Officer.

### Lookout Working

- Lookout Working must be implemented in accordance with NWT 310 Lookout Working.
- Lookout Working must not be implemented where worksites within an LPA are already established.

This is an uncontrolled copy. Before use, make sure that this is the current version by visiting [www.railsafe.org.au/safe-tracks](http://www.railsafe.org.au/safe-tracks)

## Joining an established worksite

Protection Officers joining an established worksite within a Local Possession Authority (LPA) must make sure that they receive a worksite protection briefing from the Protection Officer of the LPA worksite.

## Intermediate access routes

The Possession Protection Officer must make sure that, for each intermediate access route:

- blocking facilities have been applied to prevent unauthorised rail traffic from entering the LPA, or
- if blocking facilities cannot be applied, points allowing entry to the LPA must be clipped and locked, or
- if a worksite will be established within 500m of the protecting controlled absolute signal, points allowing entry to the LPA must be clipped and locked.

## Rail traffic

Only rail traffic associated with an LPA may enter the LPA limits.

Other rail traffic may cross the LPA to enter or exit a balloon loop or siding, but only with the Possession Protection Officer's agreement.

The Possession Protection Officer or delegate must manage all rail traffic movements within the LPA.

Rail traffic movements within worksite limits must not exceed 25km/h.

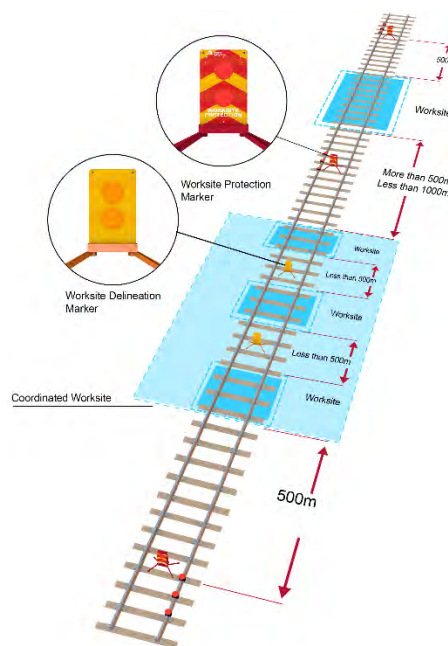

**FIGURE 1:** Example of protection arrangements for worksites and coordinated worksites between 500m and 1000m apart.

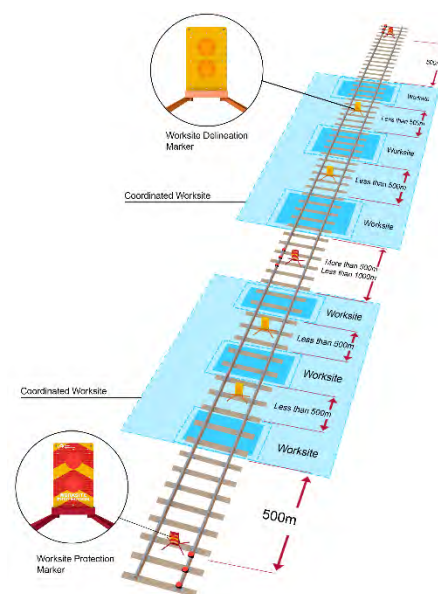

**FIGURE 2:** Example of protection arrangements for coordinated worksites between 500m and 1000m apart