

ASB Worksite Protection for Glenfield Routine Network Maintenance Activities

DOCUMENT NO.	D2023/5466
WORK DESCRIPTION	Routine network maintenance activities
WPP Number	SW19C 15081
SCOPE:	<p>This SWI is applicable for the worksite protection arrangements using ASB concerning routine network maintenance, defect management and repair of assets within the limits specified below and in the attached plan.</p> <p>Work activities include:</p> <ul style="list-style-type: none"> Routine preventative and corrective work such as inspections and maintenance as appropriate for the type of protection being applied as part of this plan.
AUTHORISATIONS:	Protection Officer: Protection Officer Level 1 or higher
SAFETY CONTROLS - Absolute Signal Blocking (ASB) arrangements:	<p>ASB established to exclude rail traffic on the</p> <ul style="list-style-type: none"> Down East Hills Line between GD 5 Signal and GD 11 Signal. <p>For reference only.</p> <p>The assessed ASB protection is:</p> <ul style="list-style-type: none"> GD 1 and GD 5 Signals at STOP with blocking facilities applied on the Down East Hills Line GD 7 Signal at stop with blocking facilities applied on the Down Main South Line. 50 points and 53 points secured to prevent rail traffic from entering the worksite on the Down Main South Line.
PRESTART REQUIREMENTS:	<p>Protection Officer assessment checklist must be completed before instructions in this SWI are followed.</p> <p>Tools and equipment required:</p> <ul style="list-style-type: none"> Protection Officer requires a phone to contact the Signaller.
FURTHER INFORMATION:	<p><i>NWT 300 Planning work in the Rail Corridor</i></p> <p><i>NWT 308 Absolute Signal Blocking</i></p> <p><i>NPR 703 Using Absolute Signal Blocking</i></p> <p><i>NGE 200 Walking in the Danger Zone</i></p> <p><i>NLA 510 - Sydenham to Glenfield</i></p>

ASB Worksite Protection for Glenfield Routine Network Maintenance Activities

Protection Officer assessment checklist

Protection Officer's name:

Yes

(Tick if Yes)

This document has not expired 12 months beyond the issue date.

On-site safety assessment has been completed and additional hazards and controls recorded on the pre-work briefing (Page 3).

SWI details and protection arrangements have been reviewed and validated for the assessed worksite location.

Corridor Safety Number

Protection Officer Signature

Date

Warning



If an above item does not apply, the Protection Officer must not use this Safe Work Instruction. A new worksite protection plan must be completed in accordance with NRF 014 Worksite Protection Pre-work briefing and NRF 015 Worksite Protection Plan.

ASB Worksite Protection for Glenfield Routine Network Maintenance Activities

Worksite Protection Pre-work Briefing

Briefing date: / /

Protection Officer details

 name signature contact No.Work location: Scope of work: Worksite protection: Refer to Worksite Protection Plan for details

Hazards (e.g. environment, plant, equipment, human error)	Controls (to be implemented to eliminate or reduce the risk to the lowest practicable level)	Person responsible for Control
Approaching rail traffic	Implement ASB as per Network Rules and Procedures. Workers to remain within worksite limits. Workers are to stop work and move to a safe place immediately on being warned by the Protection Officer.	Protection Officer
Adjacent live lines	Designated work and walk areas as instructed by the Protection Officer. Workers must remain within the ASB nominated worksite location limits whilst work is being performed.	Protection Officer
Access to / Egress from worksite	Protection Officer will assess and instruct when it is safe for workers to use <i>NGE 200 Walking in the Danger Zone</i> to move to and from the worksite or safe place.	All
Mobile phone distraction	Mobile phone usage is not allowed in the Danger Zone without prior consent of the Protection Officer.	All

☐

A final site inspection has been conducted immediately before commencing work, and any new hazards and controls have been included.

ASB Worksite Protection for Glenfield Routine Network Maintenance Activities



name	contact No.
Emergency assembly point:	SWMS/SWI Ref #:
First aid kit location:	First aider:

Yes ☐

signature

<input type="checkbox"/> have been informed of the requirements of the electrical permit (if required)	<input type="checkbox"/> have been made aware of any hazardous materials/substances on site
<input type="checkbox"/> have been briefed on the SWMS/SWIs/documentated safe work practice for the job	<input type="checkbox"/> have been briefed on Safety Data Sheets (SDS)
<input type="checkbox"/> have been instructed in the controls recorded in this document and SWMS/SWIs	<input type="checkbox"/> have been briefed on the WHS Management plan
	<input type="checkbox"/> have been briefed on the hazards of adjoining worksites/processes.

[illegible]

Safe Work Instruction

ASB Worksite Protection for Glenfield Routine Network Maintenance Activities



Worksite Protection Plan – Absolute Signal Blocking

1. ASB request – Protection Officer Details

name	signature	contact No.
RSW or RIW No.	designation	Planned Duration

Type of work: **Routine network maintenance activities**

2. Worksite location

on the **Down East Hills line** from **GD 5 Signal** to **GD 11 Signal**

3. Protection to be used

Signal(s) at STOP with blocking facilities applied ☐ Points Secured ☐

Protection is required from other Signallers at Location / panel Location / panel

4. Assurances

All points of entry into the affected portion of track are protected and blocking facilities applied ☐

The last rail traffic to pass the protection was rail traffic ID The last known location of rail traffic is location

Confirm that there is no rail traffic between the protection and the worksite ☐

5. Authorisation

Authorised by Signaller

name Glenfield Panel hr / /

Protection Number Notes

6. Temporarily Suspending ASB

Provide the name and worksite location <input type="checkbox"/>	Provide the name and worksite location <input type="checkbox"/>	Provide the name and worksite location <input type="checkbox"/>
Workers and equipment are clear of the Danger Zone <input type="checkbox"/>	Workers and equipment are clear of the Danger Zone <input type="checkbox"/>	Workers and equipment are clear of the Danger Zone <input type="checkbox"/>
Provide protection number <input type="checkbox"/>	Provide protection number <input type="checkbox"/>	Provide protection number <input type="checkbox"/>
ASB suspended at <input type="text"/> hr	ASB suspended at <input type="text"/> hr	ASB suspended at <input type="text"/> hr

7. Re-establish ASB assurances

The worksite location is identical <input type="checkbox"/>	The worksite location is identical <input type="checkbox"/>	The worksite location is identical <input type="checkbox"/>
All points of entry into the affected portion of track are protected and blocking facilities applied <input type="checkbox"/>	All points of entry into the affected portion of track are protected and blocking facilities applied <input type="checkbox"/>	All points of entry into the affected portion of track are protected and blocking facilities applied <input type="checkbox"/>
The last rail traffic to pass the protection was <input type="text"/> rail traffic ID	The last rail traffic to pass the protection was <input type="text"/> rail traffic ID	The last rail traffic to pass the protection was <input type="text"/> rail traffic ID
The last known location of rail traffic is <input type="text"/> location	The last known location of rail traffic is <input type="text"/> location	The last known location of rail traffic is <input type="text"/> location
There is no approaching rail traffic between the protection and the worksite <input type="checkbox"/>	There is no approaching rail traffic between the protection and the worksite <input type="checkbox"/>	There is no approaching rail traffic between the protection and the worksite <input type="checkbox"/>
ASB re-established at <input type="text"/> hr	ASB re-established at <input type="text"/> hr	ASB re-established at <input type="text"/> hr
Protection Number <input type="text"/>	Protection Number <input type="text"/>	Protection Number <input type="text"/>

8. Ending

Provide name and worksite location ☐ Workers and equipment clear of the Danger Zone ☐ Provide protection number ☐ Ended at hr

ASB Worksite Protection for Glenfield Routine Network Maintenance Activities

6. Temporarily Suspending ASB

Provide the name and worksite location	<input type="checkbox"/>	Provide the name and worksite location	<input type="checkbox"/>	Provide the name and worksite location	<input type="checkbox"/>
Workers and equipment are clear of the Danger Zone	<input type="checkbox"/>	Workers and equipment are clear of the Danger Zone	<input type="checkbox"/>	Workers and equipment are clear of the Danger Zone	<input type="checkbox"/>
Provide protection number	<input type="checkbox"/>	Provide protection number	<input type="checkbox"/>	Provide protection number	<input type="checkbox"/>
ASB suspended at	<input type="text"/> hr	ASB suspended at	<input type="text"/> hr	ASB suspended at	<input type="text"/> hr

7. Re-establish ASB assurances

The worksite location is identical	<input type="checkbox"/>	The worksite location is identical	<input type="checkbox"/>	The worksite location is identical	<input type="checkbox"/>
All points of entry into the affected portion of track are protected and blocking facilities applied	<input type="checkbox"/>	All points of entry into the affected portion of track are protected and blocking facilities applied	<input type="checkbox"/>	All points of entry into the affected portion of track are protected and blocking facilities applied	<input type="checkbox"/>
The last known location of rail traffic is	<input type="text"/> location	The last known location of rail traffic is	<input type="text"/> location	The last known location of rail traffic is	<input type="text"/> location
There is no approaching rail traffic between the protection and the worksite	<input type="checkbox"/>	There is no approaching rail traffic between the protection and the worksite	<input type="checkbox"/>	There is no approaching rail traffic between the protection and the worksite	<input type="checkbox"/>
ASB re-established at	<input type="text"/> hr	ASB re-established at	<input type="text"/> hr	ASB re-established at	<input type="text"/> hr
Protection Number	<input type="text"/>	Protection Number	<input type="text"/>	Protection Number	<input type="text"/>

Notes

6. Temporarily Suspending ASB

Provide the name and worksite location	<input type="checkbox"/>	Provide the name and worksite location	<input type="checkbox"/>	Provide the name and worksite location	<input type="checkbox"/>
Workers and equipment are clear of the Danger Zone	<input type="checkbox"/>	Workers and equipment are clear of the Danger Zone	<input type="checkbox"/>	Workers and equipment are clear of the Danger Zone	<input type="checkbox"/>
Provide protection number	<input type="checkbox"/>	Provide protection number	<input type="checkbox"/>	Provide protection number	<input type="checkbox"/>
ASB suspended at	<input type="text"/> hr	ASB suspended at	<input type="text"/> hr	ASB suspended at	<input type="text"/> hr

7. Re-establish ASB assurances

The worksite location is identical	<input type="checkbox"/>	The worksite location is identical	<input type="checkbox"/>	The worksite location is identical	<input type="checkbox"/>
All points of entry into the affected portion of track are protected and blocking facilities applied	<input type="checkbox"/>	All points of entry into the affected portion of track are protected and blocking facilities applied	<input type="checkbox"/>	All points of entry into the affected portion of track are protected and blocking facilities applied	<input type="checkbox"/>
The last known location of rail traffic is	<input type="text"/> location	The last known location of rail traffic is	<input type="text"/> location	The last known location of rail traffic is	<input type="text"/> location
There is no approaching rail traffic between the protection and the worksite	<input type="checkbox"/>	There is no approaching rail traffic between the protection and the worksite	<input type="checkbox"/>	There is no approaching rail traffic between the protection and the worksite	<input type="checkbox"/>
ASB re-established at	<input type="text"/> hr	ASB re-established at	<input type="text"/> hr	ASB re-established at	<input type="text"/> hr
Protection Number	<input type="text"/>	Protection Number	<input type="text"/>	Protection Number	<input type="text"/>

ASB Worksite Protection for Glenfield Routine Network Maintenance Activities

INSTRUCTIONS:

1. Workers enter the rail corridor via access gate **M25 32.191 D**.
2. Protection Officer briefs workers about the worksite protection arrangements.
3. Protection Officer contacts the Signaller at Glenfield Panel to request ASB.
4. After ASB has been authorised, start work within the limits of the nominated worksite location.
5. After work is complete, workers move to a safe place.
6. Protection Officer contacts the Signaller at Glenfield Panel to end ASB.
7. Repeat steps 4 – 6 until work is complete.
8. All workers egress the rail corridor via access gate **M25 32.191 D**.

ADDITIONAL DETAILSSuspending ASB

If the ASB is required to be suspended, the Protection Officer must make sure all workers and equipment are clear of the Danger Zone and are in a safe place before suspending the ASB.

IMAGES:

Image 1 View of worksite towards Casula station



Image 2: View of worksite towards Glenfield station

Image 3: access gate **M25 32.191 D****Diagram Glenfield**

ASB Worksite Protection for Glenfield Routine Network Maintenance Activities

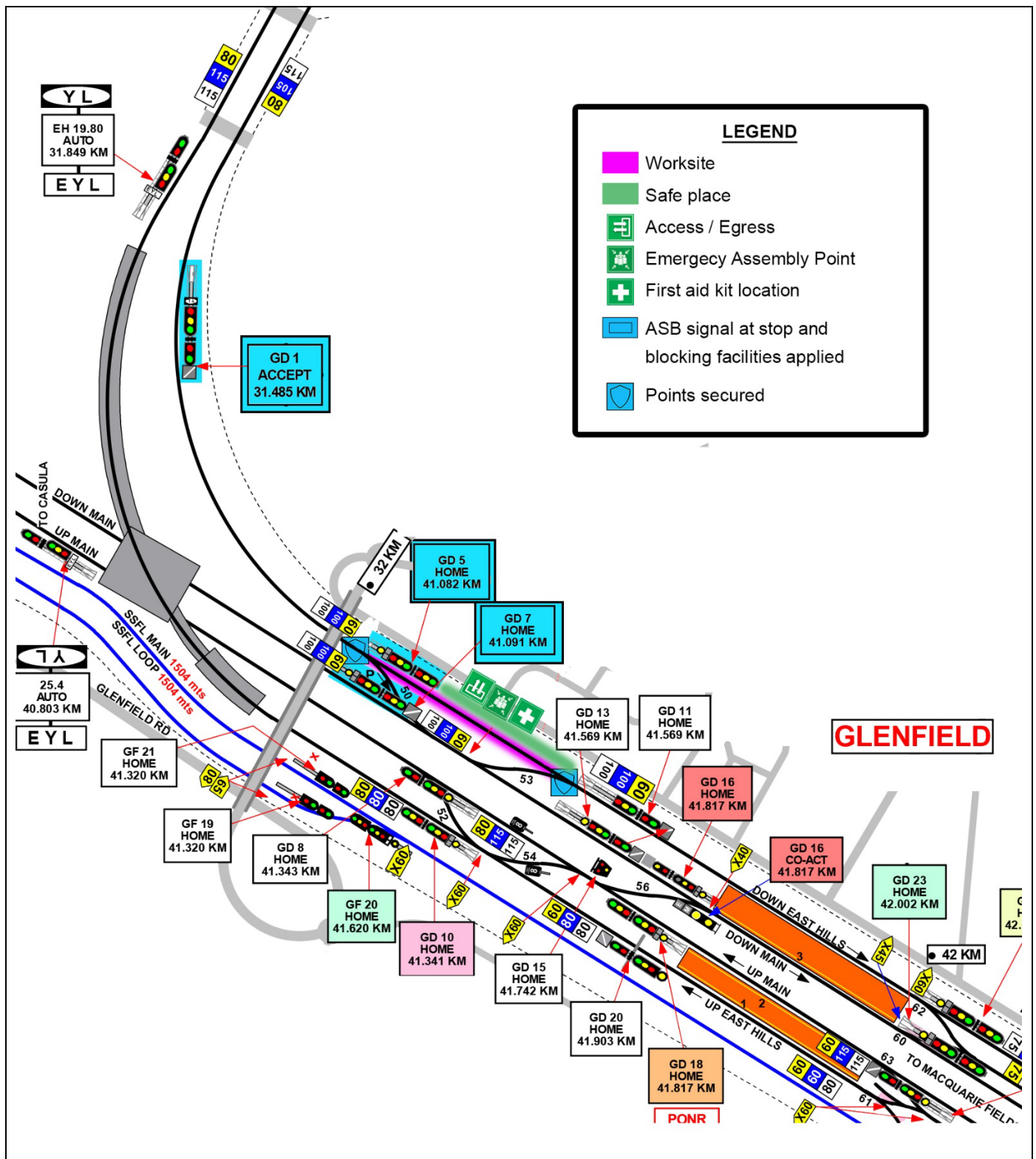

[illegible]