

41

weekly notice

Monday, 02 October 2023

Sunday, 08 October 2023

RailSafe



See online for all Safeworking Information

www.railsafe.org.au

Safeworking information, including Weekly Notices and SAFE Notices, is available on the RailSafe website.

By accessing Weekly Notices and SAFE Notices online, you will receive safety information more quickly. Weekly Notices remain on the RailSafe website for two years; Permanent and Temporary SAFE Notices remain online as long as they are current.

Anyone needing back issues of Weekly Notices and SAFE Notices should contact the Network Rules unit.

If you are outside Sydney Trains, you can reach the RailSafe website via the following address:

www.railsafe.org.au

Other Safeworking documents, such as Network Rules, Network Procedures, Network Local Appendices, Safeworking Policies, SafeTracks flyers, and contractor information are also available online.

**Director Safety and Standards
Sydney Trains**

Continued on next page

CONTENTS

<u>PUBLICATION DEADLINES AND SUBMISSION OF ARTICLES</u>	<u>4</u>
<u>MTMS STAGE 3A – SOUTH WESTERN WORKS - DC FEEDER UPGRADES - IMPEDANCE BONDS UPGRADES AT CONISTON</u>	<u>5</u>
<u>KANGY ANGY MAINTENANCE FACILITY ADDITIONAL MF WORKS PROJECT (DIAGRAM)</u>	<u>6</u>
<u>SEFTON PARK (CENTRAL INNER WEST) – 210 & 211 TURNOUT RENEWAL</u>	<u>9</u>
<u>MTMS STAGE 2 - SOUTH COAST WORKS LNIF ASDO – SOUTH COAST</u>	<u>10</u>
<u>HURSTVILLE (ILLAWARRA MAIN) – MTMS2 FINAL – COMMISSIONING OF 984A/B POINTS CROSSOVER, 993 CATCHPOINTS & 984/993 EOLS AND PERMANENTLY BOOK OUT 989A/B POINTS CROSSOVER & EOL (DIAGRAM)</u>	<u>12</u>
<u>STATUS OF TOM NOTICES</u>	<u>15</u>
<u>STATUS OF PERMANENT SAFE NOTICES</u>	<u>17</u>
<u>STATUS OF NETWORK MANUALS AND FORMS</u>	<u>18</u>
<u>DISTRIBUTION OFFICERS</u>	<u>20</u>

PUBLICATION DEADLINES AND SUBMISSION OF ARTICLES

Dates of the next four Weekly Notices and deadlines for articles are:

<i>Weekly Notice</i>	<i>For Week</i>	<i>Deadline</i>
42	09/10/2023 – 15/10/2023	12/09/2023
43	16/10/2023 – 22/10/2023	19/09/2023
44	23/10/2023 – 29/10/2023	26/09/2023
45	30/10/2023 – 05/11/2023	03/10/2023

To meet printing and distributing schedules, articles for a Weekly Notice must be received by its deadline.

Articles submitted after a deadline will be published in the next issue of the Weekly Notice. This may result in information not being distributed in time for it to be acted upon.

When submitting articles, please include your name, position title, telephone numbers and email address at the end of the articles as shown below:

Steve Swanson

Network Rules Specialist

Tel: 02 8922 4183 (external) 2 4183 (internal)

Email: stephen.swanson@transport.nsw.gov.au

MTMS STAGE 3A – SOUTH WESTERN WORKS - DC FEEDER UPGRADES - IMPEDANCE BONDS UPGRADES AT CONISTON

Commencing at 02:00 hours on **Saturday, 7 October 2023**, and continuing until 02:00 hours Monday, 09 October 2023, the following works will be carried out:

- Impedance bond between track circuit 121AT and A119T on Down North Fork will be renewed from CIT 1400 CT1 type to SIEMENS 2000P type.
- Negative busbar at 84.295km; situated between track circuit 121AT and A119T on Down North Fork will be relocated.
- Impedance bond between track circuit 114BT and 114AT on Up Port Kembla branch will be renewed from CIT 1400 CT1 type to SIEMENS 2000P type.
- Negative busbar situated between track circuit 114BT and 114AT on Up Port Kembla branch will be relocated.

VER 12092023**Brian Spaul**

Commissioning Manager
Transport for Tomorrow
Mob: 0401 710 457
Email: bspaul@transfort.com.au

Immanuel Jegan

Signalling Design Engineer
Rail Systems Australia
Mob: 0432 972 207
Email: Immanuel.Jegan@railssystemsaustralia.com.au

KANGY ANGY MAINTENANCE FACILITY ADDITIONAL MF WORKS PROJECT

Commencing at 0200 hours on **Tuesday, 17 October 2023**, and continuing until 0200 hours on Monday, 23 October 2023, the following works will be carried out:

Signals

The final signalling arrangements are shown on the Drivers Diagram published in this Weekly Notice. The new and altered signals will display indications in accordance with Network Rules.

Additional LED-type, position light dwarf shunt signals and route indicators (where provided) will be brought into use as shown in the new and altered signal route designations table below.

As a summary, following signal alterations will be done:

Signal	Route	Km	Status	Destination	Indication	Remarks
KY225	225(S)E	94.449	Existing	Road 5	Yellow + "5"	New Route added for Road 5
KY227	227(S)E	94.449	Existing	Road 5	Yellow + "5"	New Route added for Road 5
KY238	238(S)A	94.630	New	Departure Road (KY214)	Yellow + "DR"	New Route
	238(S)B		New	Arrival Road	Yellow + "AR"	New Route
	238(S)C		New	Wash Road (KY210)	Yellow + "WR"	New Route
KY268	268(S)	94.866	New	Road 5 (KY238)	Yellow	New Route. Requires Rd.5 OHW ISOL SW "closed".

Points:

Kangy Angy 315 Point will be brought into service.

Point Number	Status	Remarks
315	Altered	315 previously clipped and XL locked normal will be brought into use. New Electro-Pneumatic Style 'A' Unit with In-Bearer Spherolock, HLM MKII point detectors and EOL for emergency manual operation.

Stop Blocks

Existing stop block will be removed as shown in the table below:

Kilometrage (Approx)	Description	Remarks
94.635	Standing Road 5	Existing stop block removed.

Telephones:

A new signal telephone will be provided adjacent to the new 315 points emergency operation lock (EOL).

Speed Limits:

Standing Road 5 and 315 points are within the Maintenance Facility yard area and are subject to the 8km/h yard speed limit.

ATRICS:

No changes required for the ATRICS control system in the Sydney Train Wyong Control Centre.

The new arrangements are depicted in the attached Signalling Arrangement diagram.

DRIVERS DIAGRAM VER 07092023**Jarrad Kircher**

Signal Commissioning Engineer, UGL Pty Limited

Mob: 0408 116 717

Email: Jarrad.Kircher@greenaspect.net

Andrew Percy

Signal Design Engineer, UGL Pty Limited

Mob: 0488 214 443

Email: andrew.percy@ugllimited.com

	ROUTE	DESTINATION	IND	TYPE
KN1	(M)	DOWN MAIN	-	-

101 PTS

	ROUTE	DESTINATION	IND	TYPE
KN3	(M)A	ARRIVAL ROAD	BOL	
	(S)A	ARRIVAL ROAD	AR	SRI
	(S)B	DEPARTURE ROAD	DR	SRI
	(M)C	DOWN MAIN	-	-
	(S)C	DOWN MAIN	DM	SRI

ACCEPTED BY KY203 3(S)A AR DM 3(S)C
 ACCEPTED BY KY205 3(S)B DR 301 PTS

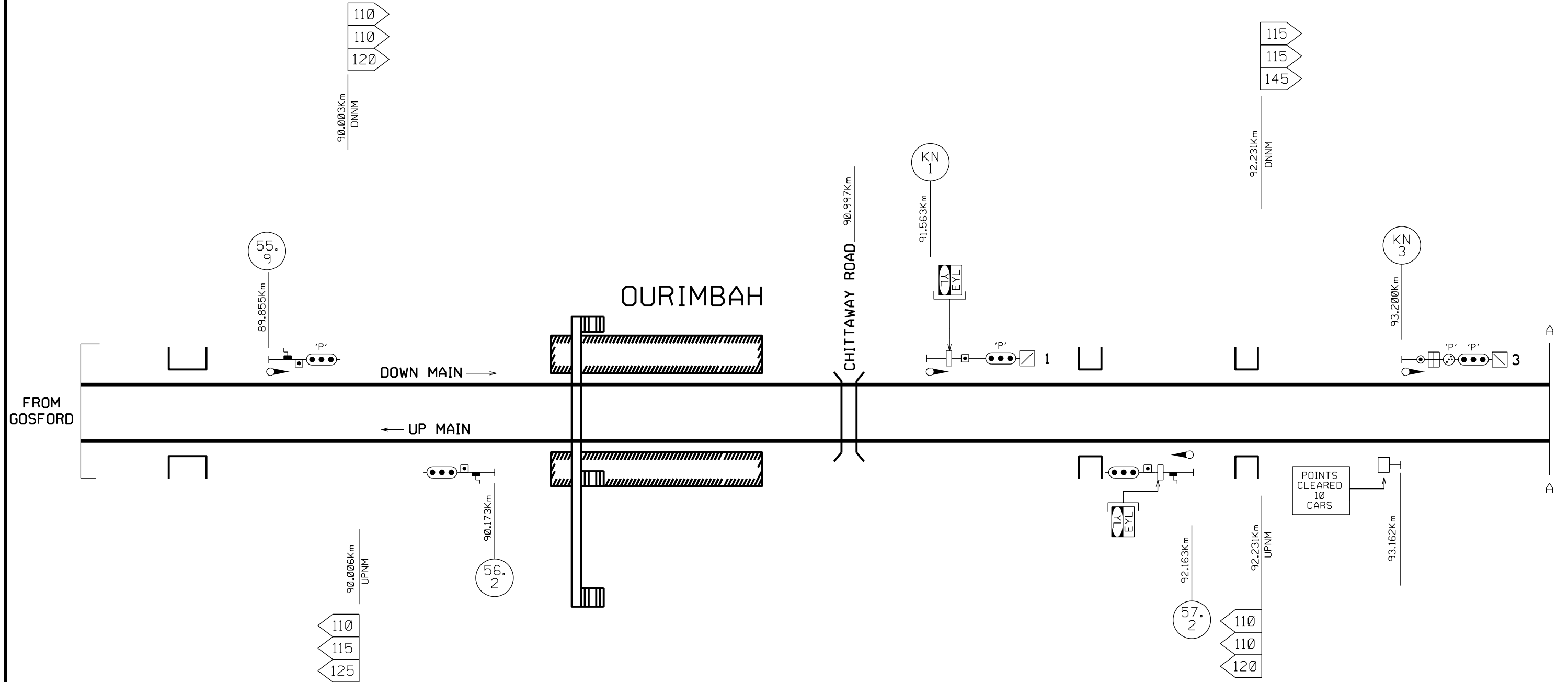

ROUTE	DESTINATION	IND	TYPE
KY 201 (S)A	WASH ROAD	WR	SRI
(M)B	ARRIVAL ROAD	AR	BOL
(S)B	ARRIVAL ROAD	AR	SRI
KY 214 (M)A	DEPARTURE ROAD	-	-
(S)A	DEPARTURE ROAD	-	-

201(S)A WR AR 201(S)B

CONTROLLED FROM WYONG ← → CONTROLLED FROM KMF

DO NOT PROCEED UNLESS AUTHORISED

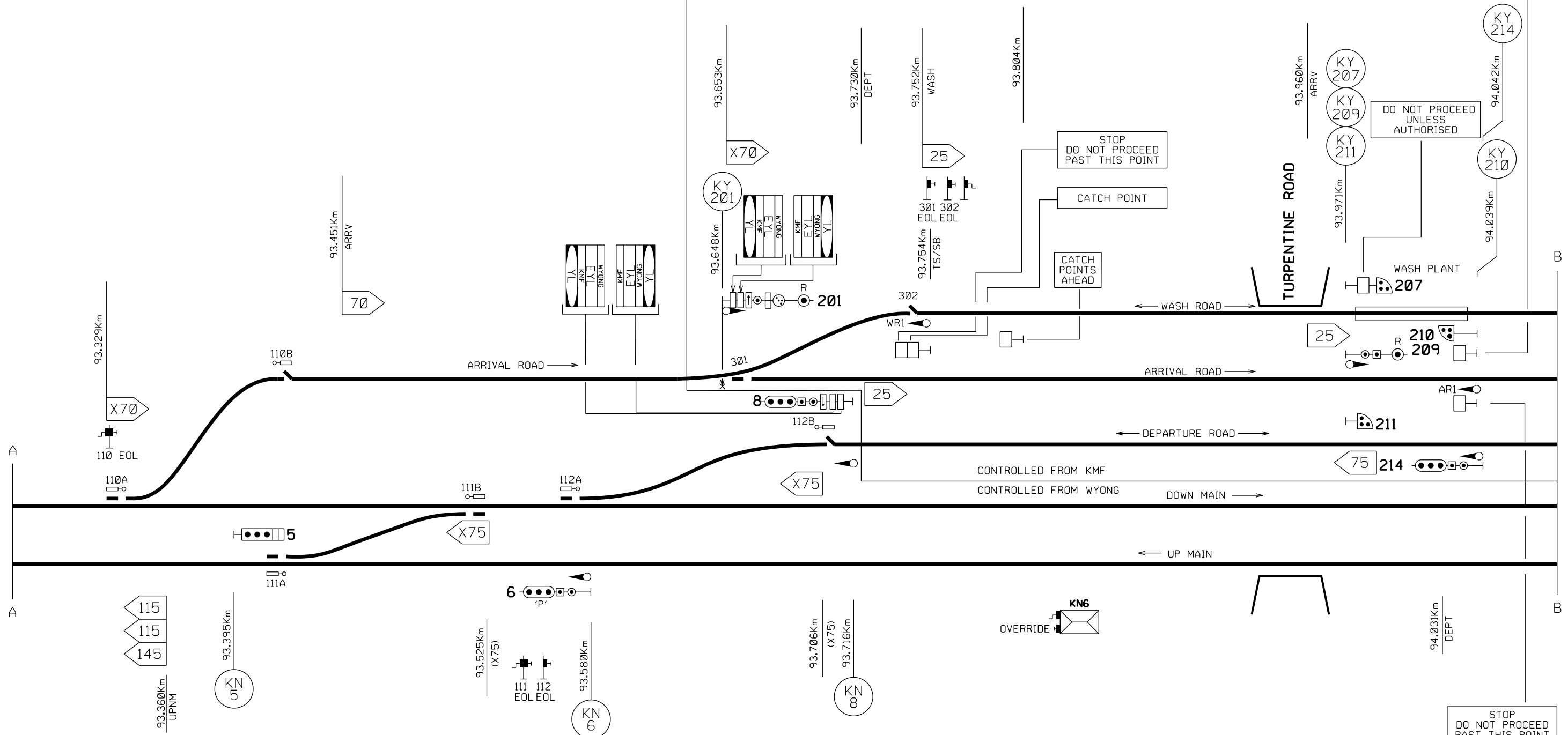

ROUTE	DESTINATION	IND	TYPE
KN5 (S)A	DEPARTURE ROAD	DR	SRI
(S)B	DOWN MAIN	DM	SRI

ACCEPTED BY KY205 5(S)A DR DM 5(S)B

ROUTE	DESTINATION	IND	TYPE
KN6 (M)	UP MAIN	-	-
(S)	UP MAIN	-	-

ROUTE	DESTINATION	IND	TYPE
KN8 (M)	UP MAIN	-	-
(S)	UP MAIN	-	-

S22071_Drivers Diagrams 07.09.2023.DGN

KY 225	ROUTE	DESTINATION	IND	TYPE	225(S)A	1	4	225(S)D
	(S)A	STANDING ROAD 1	1	MMLRI	225(S)B	2	5	225(S)E
	(S)B	STANDING ROAD 2	2	MMLRI	225(S)C	3		
	(S)C	STANDING ROAD 3	3	MMLRI				
	(S)D	STANDING ROAD 4	4	MMLRI				
(S)E	STANDING ROAD 5	5	MMLRI					

KY 234	ROUTE	DESTINATION	IND	TYPE	234(S)A	DR	WR	234(S)C
	(S)A	DEPARTURE ROAD	DR	SRI	234(S)B	AR		
	(S)B	ARRIVAL ROAD	AR	SRI	(S)C	WASH ROAD	WR	SRI

KY 227	ROUTE	DESTINATION	IND	TYPE	227(S)A	1	5	227(S)E
	(S)A	STANDING ROAD 1	1	MMLRI	227(S)B	2	WL	227(S)F
	(S)B	STANDING ROAD 2	2	MMLRI	227(S)C	3	6	227(S)G
	(S)C	STANDING ROAD 3	3	MMLRI	227(S)D	4	7	227(S)H
	(S)D	STANDING ROAD 4	4	MMLRI				
	(S)E	STANDING ROAD 5	5	MMLRI				
	(S)F	WHEEL LATHE	W	MMLRI				
(S)G	STANDING ROAD 6	6	MMLRI					
(S)H	STANDING ROAD 7	7	MMLRI					

KY 236	ROUTE	DESTINATION	IND	TYPE	236(S)A	DR	WR	236(S)C
	(S)A	DEPARTURE ROAD	DR	SRI	236(S)B	AR		
	(S)B	ARRIVAL ROAD	AR	SRI	(S)C	WASH ROAD	WR	SRI

KY 230	ROUTE	DESTINATION	IND	TYPE	230(S)A	DR	WR	230(S)C
	(S)A	DEPARTURE ROAD	DR	SRI	230(S)B	AR		
	(S)B	ARRIVAL ROAD	AR	SRI	(S)C	WASH ROAD	WR	SRI

KY 238	ROUTE	DESTINATION	IND	TYPE	238(S)A	DR	WR	238(S)C
	(S)A	DEPARTURE ROAD	DR	SRI	238(S)B	AR		
	(S)B	ARRIVAL ROAD	AR	SRI	(S)C	WASH ROAD	WR	SRI

KY 232	ROUTE	DESTINATION	IND	TYPE	232(S)A	DR	WR	232(S)C
	(S)A	DEPARTURE ROAD	DR	SRI	232(S)B	AR		
	(S)B	ARRIVAL ROAD	AR	SRI	(S)C	WASH ROAD	WR	SRI

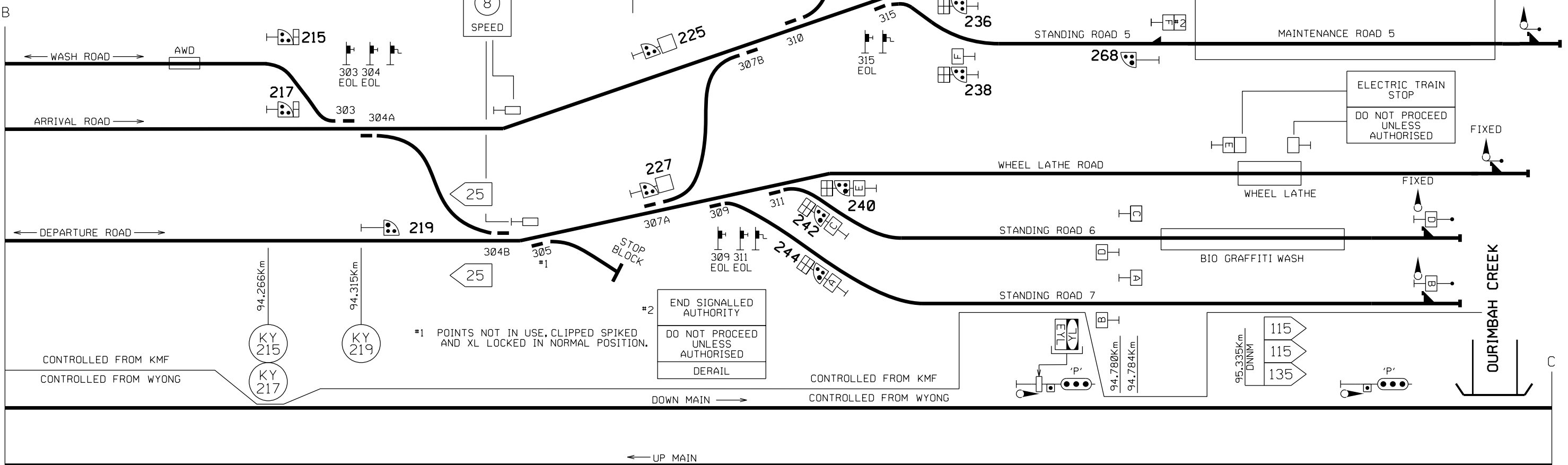

KY 215	ROUTE	DESTINATION	IND	TYPE	215(S)A	AR	DR	215(S)B
	(S)A	ARRIVAL ROAD	AR	SRI	(S)B	DEPARTURE ROAD	DR	SRI
	(S)B	DEPARTURE ROAD	DR	SRI				

KY 217	ROUTE	DESTINATION	IND	TYPE	217(S)A	AR	DR	217(S)B
	(S)A	ARRIVAL ROAD	AR	SRI	(S)B	DEPARTURE ROAD	DR	SRI
	(S)B	DEPARTURE ROAD	DR	SRI				

KY 219	ROUTE	DESTINATION	IND	TYPE	(S)A	DEPARTURE ROAD	-	-
	(S)B	PROVISION FOR FUTURE ROUTE	-	-				

KY 240	ROUTE	DESTINATION	IND	TYPE	240(S)A	DR	WR	240(S)C
	(S)A	DEPARTURE ROAD	DR	SRI	240(S)B	AR		
	(S)B	ARRIVAL ROAD	AR	SRI	(S)C	WASH ROAD	WR	SRI

KY 242	ROUTE	DESTINATION	IND	TYPE	242(S)A	DR	WR	242(S)C
	(S)A	DEPARTURE ROAD	DR	SRI	242(S)B	AR		
	(S)B	ARRIVAL ROAD	AR	SRI	(S)C	WASH ROAD	WR	SRI

KY 244	ROUTE	DESTINATION	IND	TYPE	244(S)A	DR	WR	244(S)C
	(S)A	DEPARTURE ROAD	DR	SRI	244(S)B	AR		
	(S)B	ARRIVAL ROAD	AR	SRI	(S)C	WASH ROAD	WR	SRI

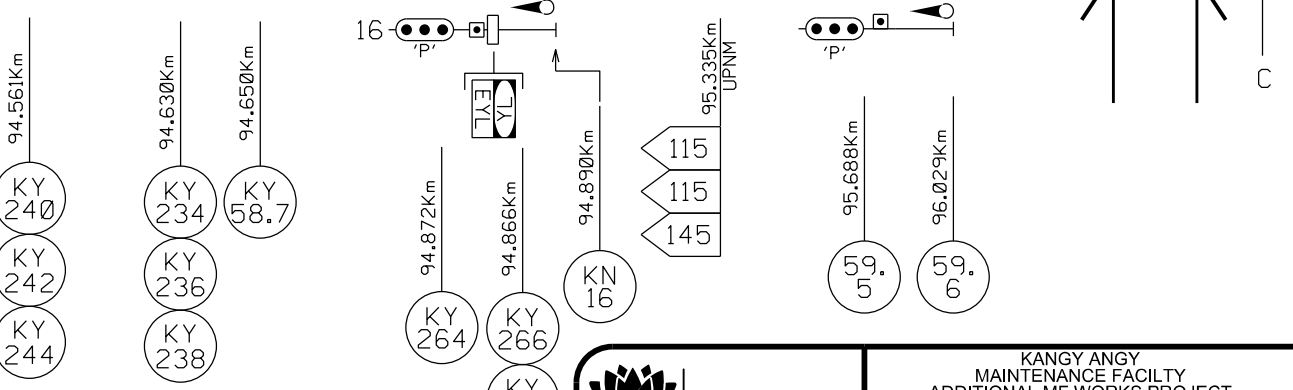

S22071_Drivers Diagrams 07.09.2023.DGN

TUGGERAH

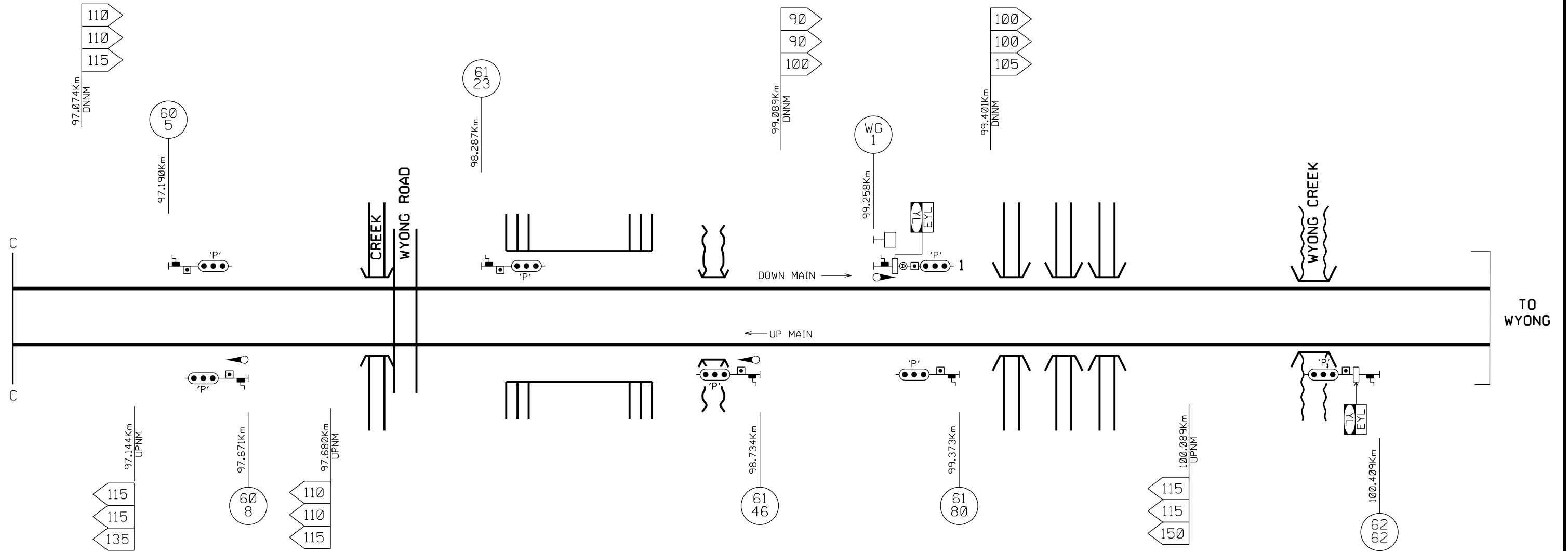

**SEFTON PARK (CENTRAL INNER WEST) – 210 & 211
TURNOUT RENEWAL**

Commencing at 0200 hours on **Saturday, 21 October 2023** and continuing until 0200 hours on Monday, 23 October 2023, the following work will be carried out:

- 210 Points at Sefton South Junction on the DOWN MAIN will be renewed and will move 0.973 metre towards country.
- 211 Points at Sefton South Junction on the UP MAIN will be renewed and will move 10.408 metres towards Sydney.
- Points mentioned above will be a like for like renewal (Siemens D84M MKIII type with an in-bearer Spherolock arrangement).
- The existing Emergency Operation Lock (EOL) for both Points will be reused and stay at same place.

VER30082023**Ben Armstrong**

Commissioning Manager

Sydney Trains

Mob: 0437402747

Email – BENJAMIN.ARMSTRONG@transport.nsw.gov.au

SHEKHAR ARORA

Signal Design Engineer,

Signalling & Control Systems, Engineering & System Integrity,

Sydney Trains

Email: shekhar.arora@transport.nsw.gov.au

MTMS STAGE 2 - SOUTH COAST WORKS LNIF ASDO – SOUTH COAST

Since 17.30 hours on **Friday 15, September 2023**, the following works were carried out:

- The Automatic Selective Door Operation (ASDO) Infrastructure trackside assets mounted within the station limits at the stations listed below have been commissioned into use. The ASDO assets comprise balises, vortok beams on the track and platform mounted plaques.
 - Dapto Platform 1 & 3
 - Kiama Platform 1
 - Port Kembla Platform 1
 - Shellharbour Platform 1 & 2
 - Thirroul Platform 1 & 2
 - Wollongong Platform 2

The following works advertised in the Weekly Notice have been deferred to a later date:

- Commissioning of the Automatic Selective Door Operation (ASDO) Infrastructure trackside assets mounted within the station limits at the stations listed below.:
 - Thirroul Platform 3
 - Bellambi Platform 1 & 2
 - Wollongong Platform 1
 - Kiama Platform 2
- The ASDO assets comprising balises, vortok beams on the track and platform mounted plaques will remain in situ. Balises will have muting covers reinstated.

VER 15082023**Sathish Veerabadrappa**

Design Delivery Manager (All sites except Shellharbour), WSP

Mob: 0420 643 374

Email: Sathish.Veerabadrappa@wsp.com

Paul Hartley

Design Delivery Manager (Shellharbour only), JMDR

Mob: 0447 429 815

Email: paul.hartley@jmdr.com

Matthew Ward

Commissioning Engineer, JMDR

Mob: 0403 689 614

Email: matthew.ward@jmdr.com

HURSTVILLE (ILLAWARRA MAIN) – MTMS2 FINAL – COMMISSIONING OF 984A/B POINTS CROSSOVER, 993 CATCHPOINTS & 984/993 EOLS AND PERMANENTLY BOOK OUT 989A/B POINTS CROSSOVER & EOL

Commencing at 0200 hours on **Saturday, 7 October 2023**, and continuing until 0200 hours on Monday, 9 October 2023, the following works will be carried out:

Alteration to Signals

- Decommission and removal of Hurstville Fixed Red Signal and Trainstop (Hurstville Station Platform 4).
- Removal of SM915 & SM917 Signage
- Commission new SM918 Signal, SM918 Co-acting signal and Trainstop. Brought into use for 918(M)A and 918(S)A routes.
- Removal of fixed red signal ahead signage at 14.944km.
- Commission new 918 Guards indicators (1) & (2) on platform 4.
- Decommission SM929 (M)C & (S)C routes to the Up Illawarra local line destination (includes removal of MLRI and UL stencil).
- Decommission SM931 (M)C & (S)C routes to the Up Illawarra local line destination (includes removal of UL stencil).
- Commission of SM936 (M)B LSp route and upgrade to LED for Up Main No.3 Platform destination (includes installation of Low Speed Aspect).
- A new LED MLRI (LH TOR) for 936 (M)C route will be brought into use for Down Main No. 4 Platform destination (includes installation of MLRI).
- Commission SM938(M)B LSp route and upgrade to LED for Up Main destination (includes installation of Low Speed aspect).

- Decommission SM940 (M)B, (S)B, (M)C, (S)C routes and upgrade to LED. The decommission routes are for the Down Illawarra Local and Up Illawarra Main destinations (includes removal of MLRI and Stencil indicator).
- Decommission SM942 (S)B & (S)C routes. The decommission routes are for the Down Illawarra Local and Up Illawarra Main destinations (Includes removal of Stencil indicator).
- Commission SM946 lower green aspect.
- Relocation of 917 ITS(1) Trainstop.
- Commission 936/938 ITS(1) & ITS(2) Trainstop.

Alteration to Points

- Commission of 984A/B points and 993 catch points and EOL box into service.
- Decommission 989 A&B Points, points to be XL locked, spiked and detected in normal. Loss of point normal detection will drop 938AT and 940BT tracks.
- ATRICS display updated to show 984A/B Crossover and 993 Catch point in service. 989A/B Crossover will be displayed as an unindicated asset on the ATRICS display.

Alteration to ATP

- Commission HVLA984B_DNIA_0_F, HVLA984B_DNIA_1_F, HVLSM917_UPIA_0_F, HVLSM917_UPIA_1_F, HVLSM929_UPIA_0_C and HVLSM292_UPIA_1_F balise.
- Decommission of HVLSM917_UPIA_0_C, HVLSM917_UPIA_1_F, HVL01472_DNIA_1_F, HVL01472_DNIA_0_F, HVL01474_UPIA_1_F, HVL01474_0_F, HVL989B_UPIL_1_F, HVL989B_UPIL_0_F, HVL989A_UPIL_0_F, HVL989A_UPIL_1_F, HVL989A_UPIA_0_F and HVL989A_UPIA_1F balise.

A driver's diagram with the altered arrangement is provided with this weekly notice.

VER22082023**Mark Skribins**

Signalling Commissioning Manager

Mob: +61 412 520 806

Email: mark.skribins@jhg.com.au

Gerald Chin

Principal Signalling Engineer

Mob: +61 435 631 133

Email: gerald.chin@wsp.com

TO SYDNEY

TO HURSTVILLE

911	(M)A	DN LOCAL	—
	(S)A	DN LOCAL	DL
	(M)B	UP LOCAL	—
	(S)B	UP LOCAL	UL

909	(M)A	DN MAIN	—
	(S)A	DN MAIN	DM
	(M)B	UP MAIN	—
	(S)B	UP MAIN	UM

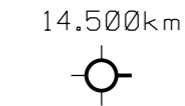

(DNIA) 14.600 km
DOWN ILLAWARRA MAIN

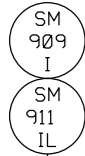

(DNIA) 14.265 km



14.260 km
AVENUE

(DNIA) 14.356 km
DOWN ILLAWARRA MAIN

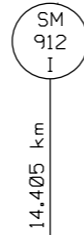
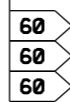

(UPIA) 14.370 km
UP ILLAWARRA MAIN



921	(S)A	DN LOCAL	DL
	(M)B	UP LOCAL	—
	(S)B	UP LOCAL	UL

921(S)



14.579 km

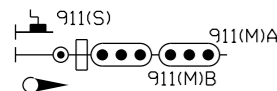
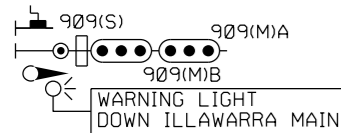

- UIL(9)WL (13.443 km) 811m, 36° @ 80KPH
- UIL(10)WL (13.563 km) 692m, 31° @ 80 KPH
- UIL(11)WL (13.602 km) 652m, 29° @ 80 KPH

14.255 km
WOIDS

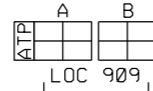

LOC 14.319 km

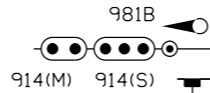
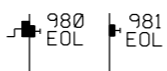

14.405 km
SM 914 IL

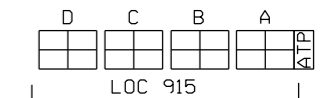

LOC 14.576 km

EMERGENCY OPERATION LOCK

MOUNTED IN CUPBOARD SECURED WITH SL LOCK
RELEASES FORTRESS KEY FOR POINTS MOTOR

POINT ARRANGEMENTS

POINTS No.	POINTS TYPE	DUAL 84M LEVER BALL BEARING REMOVED	NUMBER OF BACKDRIVES	BEARERS	MECHANICAL DRIVE	EMERGENCY OPERATION					INTERLOCKING BALL BEARING REMOVED	WIDE CUT NOTCH POSITION	FPL REMOVED
						TYPE	EOL INDEX ESML WARDING	MACHINE INDEX	LOCATION	INSCRIPTION			
980A	WBS D84 MKIII	NO	1	IN-BEARER	SPHEROLOCK	EOL KEY	A-H	A-H	909	HURSTVILLE EOL & 980A PTS. MOTOR			
980B	WBS D84 MKIII	NO	1	IN-BEARER	SPHEROLOCK	EOL KEY	A-H	A-H	909	HURSTVILLE EOL & 980B PTS. MOTOR			
981A	WBS D84 MKIII	NO	1	IN-BEARER	SPHEROLOCK	EOL KEY	A-D	A-D	909	HURSTVILLE EOL & 981A PTS. MOTOR			
981B	WBS D84 MKIII	NO	1	IN-BEARER	SPHEROLOCK	EOL KEY	A-D	A-D	909	HURSTVILLE EOL & 981B PTS. MOTOR			
984A	SIEMENS D84 MKIII		1	IN-BEARER	SPHEROLOCK	EOL KEY	A-K	A-K	915	HURSTVILLE EOL & 984A PTS. MOTOR	NO	N/A	N/A
984B	SIEMENS D84 MKIII		1	IN-BEARER	SPHEROLOCK	EOL KEY	A-K	A-K	915	HURSTVILLE EOL & 984B PTS. MOTOR	NO	N/A	N/A
993	SIEMENS D84 MKIII		-	IN-BEARER	SPHEROLOCK	EOL KEY	A-J	A-J	915	HURSTVILLE EOL & 993 PTS. MOTOR	NO	N/A	N/A



HURSTVILLE (ILLAWARRA MAIN) - MTMS2 STAGE FINAL

PART SIGNALLING ARRANGEMENT
SHEET 1 OF 4

TO SYDNEY

TO PENSHURST

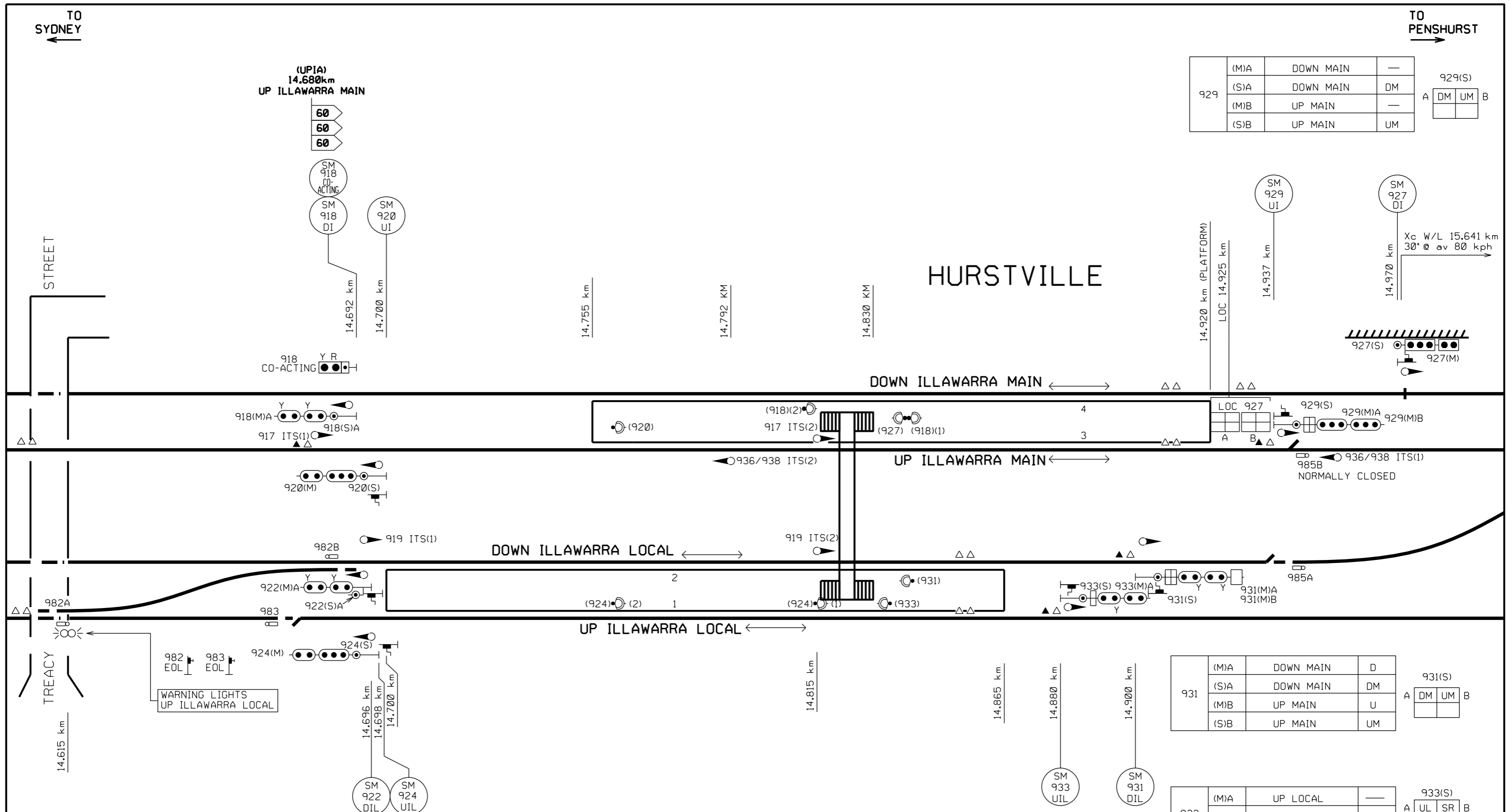

929	(M)A	DOWN MAIN	—	929(S)	A	DM	UM	B
	(S)A	DOWN MAIN	DM					
	(M)B	UP MAIN	—					
	(S)B	UP MAIN	UM					

931	(M)A	DOWN MAIN	D	931(S)	A	DM	UM	B
	(S)A	DOWN MAIN	DM					
	(M)B	UP MAIN	U					
	(S)B	UP MAIN	UM					

933	(M)A	UP LOCAL	—	933(S)	A	UL	SR	B
	(S)A	UP LOCAL	UL					
	(S)B	STABLING ROAD	SR					

EMERGENCY OPERATION LOCK
MOUNTED IN CUPBOARD SECURED WITH SL LOCK
RELEASES FORTRESS KEY FOR POINTS MOTOR

POINTS	TYPE	INDEX	KEY	INSCRIPTION
WBS D84M MKIII	982A	AE	FORTRESS	HURSTVILLE EOL AND 982A PTS MOTOR
WBS D84M MKIII	982B	AE	FORTRESS	HURSTVILLE EOL AND 982B PTS MOTOR
WBS D84M MKIII	983	AF	FORTRESS	HURSTVILLE EOL AND 983 PTS MOTOR

EMERGENCY OPERATION LOCK
MOUNTED IN CUPBOARD SECURED WITH SL LOCK
RELEASES FORTRESS KEY FOR POINTS MOTOR

POINTS No.	POINTS TYPE	No. OF BACKDRIVES	BEARERS	MECHANICAL DRIVE	EMERGENCY OPERATION				INSCRIPTION
					TYPE	EOL INDEX ESML WARDING	MACHINE INDEX	LOCATION	
985A	WBS D84 MKIII	-	CONCRETE	SPHEROLOCK	EOL KEY	A-G	A-G	934	HURSTVILLE 985A EOL & 985A CPTS. MOTOR
985B	WBS D84 MKIII	-	CONCRETE	SPHEROLOCK	EOL KEY	A-G	A-G	934	HURSTVILLE 985B EOL & 985B CPTS. MOTOR



HURSTVILLE (ILLAWARRA MAIN) - MTMS2 STAGE FINAL
PART SIGNALLING ARRANGEMENT
SHEET 2 OF 4

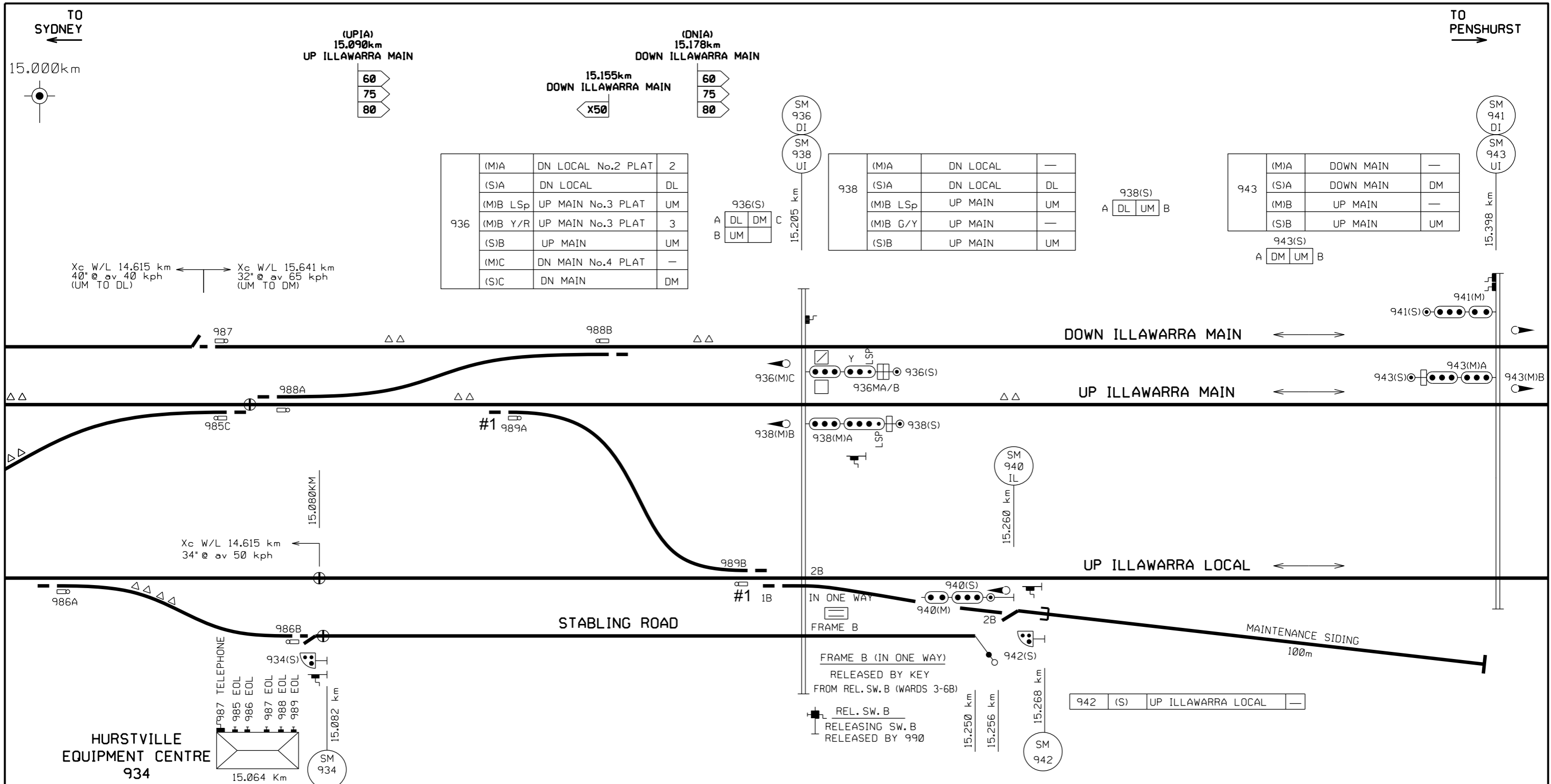

Xc W/L 14.615 km
40° @ av 40 kph
(UM TO DL)

Xc W/L 15.641 km
32° @ av 65 kph
(UM TO DM)

Xc W/L 14.615 km
34° @ av 50 kph

**HURSTVILLE
EQUIPMENT CENTRE
934**

EMERGENCY OPERATION LOCK
MOUNTED IN CUPBOARD SECURED WITH SL LOCK RELEASES FORTRESS KEY FOR POINTS MOTOR

POINTS No.	POINTS TYPE	DUAL 84M LEVER BALL BEARING REMOVED	No. OF BACKDRIVES	BEARERS	MECHANICAL DRIVE	EMERGENCY OPERATION			INSCRIPTION	WIDE CUT NOTCH POSITION	FPL REMOVED	
						TYPE	EOL INDEX ESML WARDING	MACHINE INDEX				
986A	WBS D84 MKIII	NO	0	IN-BEARER	SPHEROLOCK	EOL KEY	A-H	A-H	934	HURSTVILLE 986A EOL & 986A PTS. MOTOR	N/A	N/A
986B	WBS D84 MKIII	NO	0	IN-BEARER	SPHEROLOCK	EOL KEY	A-H	A-H	934	HURSTVILLE 986B EOL & 986B CPTS. MOTOR	N/A	N/A

POINTS No.	POINTS TYPE	No. OF BACKDRIVES	BEARERS	MECHANICAL DRIVE	EMERGENCY OPERATION			INSCRIPTION	
					TYPE	EOL INDEX ESML WARDING	MACHINE INDEX		
985A	WBS D84 MKIII	-	CONCRETE	SPHEROLOCK	EOL KEY	A-G	A-G	934	HURSTVILLE 985A EOL & 985A CPTS. MOTOR
985B	WBS D84 MKIII	-	CONCRETE	SPHEROLOCK	EOL KEY	A-G	A-G	934	HURSTVILLE 985B EOL & 985B CPTS. MOTOR
985C	WBS D84 MKIII	1	CONCRETE	SPHEROLOCK	EOL KEY	A-G	A-G	934	HURSTVILLE 985C EOL & 985C PTS. MOTOR
987	WBS D84 MKIII	-	CONCRETE	SPHEROLOCK	EOL KEY	A-F	A-F	934	HURSTVILLE 987 EOL & 987 CPTS. MOTOR
988A	WBS D84 MKIII	1	CONCRETE	SPHEROLOCK	EOL KEY	A-D	A-D	934	HURSTVILLE 988A EOL & 988A PTS. MOTOR
988B	WBS D84 MKIII	1	CONCRETE	SPHEROLOCK	EOL KEY	A-D	A-D	934	HURSTVILLE 988B EOL & 988B PTS. MOTOR
#1 989A	WBS D84 MKIII	1	CONCRETE	SPHEROLOCK	EOL KEY	A-E	A-E	934	HURSTVILLE 989A EOL & 989A PTS. MOTOR
#1 989B	WBS D84 MKIII	1	CONCRETE	SPHEROLOCK	EOL KEY	A-E	A-E	934	HURSTVILLE 989B EOL & 989B PTS. MOTOR

NOTES:
#1 989A & 989B POINTS CLIPPED, XL LOCKED, SPIKED & DETECTED NORMAL.



HURSTVILLE (ILLAWARRA MAIN) - MTMS2 STAGE FINAL
PART SIGNALLING ARRANGEMENT
SHEET 3 OF 4

TO SYDNEY

TO PENSHURST

15.500km



15.534 Km
Xc W/L 16.217km
30° @ 85kph

WARNING LIGHT
DOWN ILLAWARRA MAIN

DOWN ILLAWARRA MAIN
60
60
60

THIS SIGNAL MUST NOT BE PASSED AT STOP WITHOUT AUTHORITY FROM THE SIGNALLER

THIS SIGNAL MUST NOT BE PASSED AT STOP WITHOUT AUTHORITY FROM THE SIGNALLER

DOWN ILLAWARRA MAIN →

← UP ILLAWARRA MAIN

(UPIA)
15.665km
X50 X50

DOWN ILLAWARRA MAIN (DNIA)
15.830km

ETCS HAZARD POINT

UP ILLAWARRA LOCAL

UP ILLAWARRA MAIN (UPIA)
15.661km

THIS SIGNAL MUST NOT BE PASSED AT STOP WITHOUT AUTHORITY FROM THE SIGNALLER

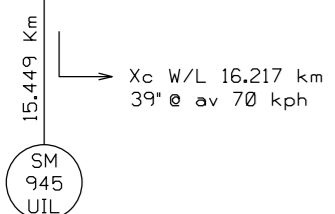
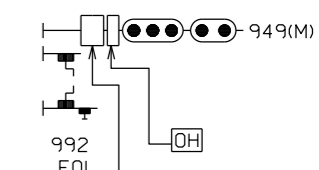
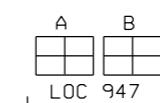
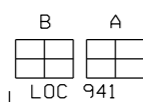
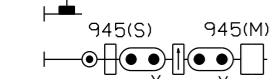

LOC 15.500 Km

(UPI)
15.565km
UP ILLAWARRA LOCAL
50
50
55

UP ILLAWARRA LOCAL (UPI)
15.554km

945	(M)A	DOWN MAIN	D	A	945(S) DM UM B
	(S)A	DOWN MAIN	DM		
	(M)B	UP MAIN	U		
	(S)B	UP MAIN	UM		

948	(M)A	UP LOCAL	—	A	948(S) UL UM B
	(S)A	UP LOCAL	UL		
	(M)B	UP MAIN	—		
	(S)B	UP MAIN	UM		

POINT ARRANGEMENT

POINTS No.	POINTS TYPE	DUAL 84M LEVER BALL BEARING REMOVED	No. OF BACKDRIVES	BEARERS	MECHANICAL DRIVE	EMERGENCY OPERATION			INSCRIPTION	
						TYPE	EOL INDEX ESML WARDING	MACHINE INDEX LOCATION		
991A	WBS D84 MKIII	-	-	IN BEARERS	SPHEROLOCK	EOL KEY	AD	AD	'A' END	HURSTVILLE EOL & 991A CPTS. MOTOR
991A	WBS D84 MKIII	-	1	IN BEARERS	SPHEROLOCK	EOL KEY	AD	AD	'A' END	HURSTVILLE EOL & 991A CPTS. MOTOR
992A	WBS D84 MKIII	NO	1	IN BEARERS	SPHEROLOCK	EOL KEY	AH	AH	947	HURSTVILLE EOL & 992A PTS. MOTOR
992B	WBS D84 MKIII	NO	1	IN BEARERS	SPHEROLOCK	EOL KEY	AH	AH	947	HURSTVILLE EOL & 992B PTS. MOTOR

EMERGENCY SWITCH MACHINE LOCK (ESML)
MOUNTED IN CUPBOARD, SECURED BY S.L.LOCK
RELEASES KEY WITH CRANK HANDLE

POINTS TYPE	POINTS	WARDING	INDEX
WBS M3	991	2-5A	AD
WBS M3	992	1-3A	AH



HURSTVILLE (ILLAWARRA MAIN) - MTMS2 STAGE FINAL

PART SIGNALLING ARRANGEMENT
SHEET 4 OF 4

STATUS OF TOM NOTICES

<i>Number</i>	<i>Title</i>	<i>Issued</i>	<i>Effective</i>
018 – 2007	Emergency equipment boxes Rail	01/11/07	19/11/07
010 – 2012	48 Class: Train Operations Manual (TOM)	25/10/12	04/11/12
003 – 2013	48 Class: Wheels	07/02/13	10/02/13
015 – 2013	OMET 200: Minimum Standards for Electric Trains	30/05/13	09/06/13
002 – 2014	OMET 220: Wheelslip light indications	20/02/14	02/03/14
004 – 2016	OMET 262: Failure of Train Management System	14/07/16	24/07/16
004 – 2017	TWP 174 Ice Radio	20/07/17	31/07/17
018 - 2017	Amendment to OMET 200	14/12/17	24/12/17
012 – 2018	OMET 228 Control Circuit Failure	23/08/18	02/09/18
005 – 2018	OMET 242 Reverser handle jams in forward or reverse	18/08/18	28/08/18
006 – 2018	OMET 250 Applying power from the rear	18/08/18	28/08/18
008 – 2018	TWP 154 Responding to incapacitated Driver/Guard	18/08/18	28/08/18
016 - 2018	Network Rules Operational standards update	17/08/18	27/08/18
003 - 2019	OMET 264: Minimum Tractive Effort Requirements	21/02/19	03/03/19
012 – 2019	TWP 192: Working Trains Out of service	21/02/19	03/03/19
007 – 2019	TWP 136 Defective wheels	06/03/19	24/03/19
008 – 2019	TWP 190 Automatic Train Protection	06/03/19	24/03/19
009 – 2019	Train crew relieved in service & relay driver	06/03/19	24/03/19
014 – 2019	OSCAR Internal Emergency Door Releases	14/03/19	24/03/19
004 – 2019	TWP 118 Reporting Faults	11/04/19	28/04/19
004 - 2020	TWP 124 Defective Brakes	20/05/20	08/06/20
005 - 2020	TWP 126 Defective Automatic Brakes	20/05/20	08/06/20
012 - 2020	WAR 202 Bogie Faults	20/05/20	08/06/20
011 - 2020	TWP 162 Train Crew Bell Signals	02/06/20	15/06/20
014 - 2020	TWP 112 Changing ends	20/07/20	03/08/20
017 - 2020	Operating Tangara, OSCAR, Millenium and Waratah with deflated air springs in the city underground	07/12/20	14/12/20
011 - 2021	Exception to OMET 200 & 350	17/11/21	29/11/21
005 - 2022	TWP 160 Driver procedure at stations	21/04/22	08/05/22
023 - 2022	Exception to OMET 254 Topside Preparation Locations	16/08/22	22/08/22
028 - 2022	Testing of Tangara Sets fitted with European Train Control System (ETCS) Level 1 & Level 2 (In cab signalling) equipment at Mortdale Maintenance Centre	08/12/22	16/12/22
027 - 2022	TWP 150: Damaged or Missing Window Glass	27/09/22	10/10/22
014 - 2023	Use of Automatic Train Protection (ATP) equipment on Millennium trains	20/02/23	05/03/23
016 - 2023	TWP 152 Disabled trains	07/03/23	20/03/23
017 - 2023	TWP 138 Assisting Trains using Emergency Couplers	07/03/23	20/03/23
020 - 2023	Operation of Tangara Trains with Automatic Train Protection (ATP)	14/03/23	20/03/23
021 - 2023	Operation of Tangara fitted with Automatic Train Protection equipment	10/03/23	21/03/23

<i>Number</i>	<i>Title</i>	<i>Issued</i>	<i>Effective</i>
022 – 2023	WB Radios on Waratah, Oscar, Millenium, Tangara and K sets	05/04/23	23/04/23
023 - 2023	OSCAR trains fitted with Automatic Train Protection (ATP) equipment	19/06/23	26/06/23
024 - 2023	Waratah trains (A and B sets) fitted with Automatic Train Protection (ATP) equipment	19/06/23	26/06/23
028 – 2023	TWP 176: Wayside Train Condition Monitoring	07/08/23	21/08/23
029 - 2023	Testing of an OSCAR Set (H5) with ETCS Level 2 equipment	01/09/23	04/09/23
026 – 2023	TWP 156: Operating doors	15/09/23	25/09/23
025 - 2023	TWP 100 Responsibilities of Train Crews	15/09/23	30/09/23

STATUS OF PERMANENT SAFE NOTICES

<i>Number</i>	<i>Title</i>	<i>Issued</i>	<i>Effective</i>
001 - 2023	Use of Signal Key Switches	19/01/23	25/01/23
002 - 2023	Control of the Country Rail Network (CRN) by UGL Regional Linx (UGLRL)	16/02/23	28/02/23
003 - 2023	New Trackside Signage associated with Digital Systems Train Testing	03/02/23	25/02/23

Steve Swanson

Network Rules Specialist

Tel: 02 8922 4183 (external) 2 4183 (internal)

Email: stephen.swanson@transport.nsw.gov.au





STATUS OF NETWORK MANUALS AND FORMS**Network Manuals**

Network Local Appendices	RailSafe Website	Online documents
Operator Specific Procedures	RailSafe Website	Online documents
Network Rules	RailSafe Website	Online documents
Network Procedures	RailSafe Website	Online documents
Forms	RailSafe Website	Online documents (or order as applicable)

<i>Title</i>	<i>Status Sheet</i>	<i>Date issued</i>
<i>Train Working Procedures</i>		
TWP 100	TN 006 - 2021	April 2021
TWP 102	3	May 2012
TWP 108	4	May 2012
TWP 110	TN 009 - 2019	March 2019
TWP 112	TN 014 - 2020	August 2020
TWP 114	4	November 2015
TWP 116	3	May 2012
TWP 118	TN 004 - 2019	April 2019
TWP 120	3	May 2012
TWP 122	3	May 2012
TWP 124	TN 004 - 2020	May 2019
TWP 126	TN 005 - 2020	May 2019
TWP 128	3	May 2012
TWP 130	3	May 2012
TWP 132	3	May 2012
TWP 134	3	May 2012
TWP 136	TN 007 - 2019	March 2019
TWP 138	TN 017 - 2023	March 2023
TWP 142	3	May 2012
TWP 144	5	May 2012
TWP 146	3	May 2012
TWP 148	3	May 2012
TWP 150	TN 005 - 2017	April 2017
TWP 152	TN 016 - 2023	March 2023
TWP 154	TN 008 - 2018	July 2018
TWP 156	TN 011 - 2019	March 2019
TWP 158	3	May 2012
TWP 160	TN 005 - 2022	May 2022
TWP 162	TN 011- 2020	May 2019
TWP 164	4	May 2012
TWP 166	3	May 2012
TWP 168	3	May 2012
TWP 170	3	May 2012
TWP 172	4	May 2012
TWP 174	TN 004 - 2017	July 2017
TWP 176	TN 008 - 2017	July 2017
TWP 182	1	November 2015
TWP 188	1	November 2015
TWP 190	TN 008 - 2019	March 2019
TWP 192	TN 012 - 2019	March 2019

DISTRIBUTION OFFICERS**Sydney Trains****Safety and Environment****Maria Economou**

Safety Support

 2 4502 2 1840 Maria.Economou@transport.nsw.gov.au**Train Crew Operations****Manager Day of Operations** 8577 7029

TCOManagerDayofOperations@transport.nsw.gov.au

Train Crewing**Tim Kelly**

Operating Standards Officer

 0422088764 timothy.kelly@transport.nsw.gov.au**Service Delivery Response****Megan Parker**



Service Delivery Response

 0491226502 megan.parker@transport.nsw.gov.au**Leigh Lawton**



Service Delivery Response

 0418237261 leigh.lawton@transport.nsw.gov.au**Maintenance****Fleet Maintenance****Hoshedar Movdawalla**

Fleet Maintenance Sydney Trains

 2 0532 2 1274 HOSHEDAR.MOVDAWALLA@transport.nsw.gov.au**Ram Ramaswamy**



Fleet Maintenance Sydney Trains

 2 0523 2 1274 RAMYAVARAN.RAMASWAMY@transport.nsw.gov.au**Network Maintenance****Zaneta Janevski**

Engineering & Maintenance

 87570199 zaneta.janevski@transport.nsw.gov.au**Shannon Newton**

Track Access Coordinator – North

 95363791 Shannon.Newton@transport.nsw.gov.au**Xerxes Francia**



Track Access Coordinator – North

Hornsby Network Base

 3 6740 Xerxes.Francia@transport.nsw.gov.au**Jonathan Barnes**



Track Access Coordinator – West

Blacktown Network Base



 87512 Jonathan.Barnes@transport.nsw.gov.au**Ennio Soster**

SCE

Project Delivery Electrical

 25236 25917 ENNIO.SOSTER@transport.nsw.gov.au**Daljit Kaur**

Infrastructure Maintenance — Facilities

 2 5922 2 5950 Daljit.Kaur@transport.nsw.gov.au

Adrian Aquilina

Team leader - Strathfield Mains

 97526610 adrian.aquilina@transport.nsw.gov.au**Christina Morgan**

Administration Support

ICON

 9379 6051 Christina.Morgan@transport.nsw.gov.au**Lorinda Melvin**

Administration Support

 0439510480 lorinda.melvin@transport.nsw.gov.au**Edward Lusik**

Team Leader Signals

CBD

 95368135 edward.lusik@transport.nsw.gov.au**Major Works****Greg Page**

Infrastructure Track

 25375 gregory.page@transport.nsw.gov.au**Michael Warner**

Signals and Electricity

 9848 9333 michael.warner@transport.nsw.gov.au**Logistics & Supply Chain****Murari Singh**



Contract Assurance Administrator

 02 9848 9698 Murari.Singh@transport.nsw.gov.au**Engineering & System Integrity****Teresa Sitjar**



Signalling & Control Systems

 42458 Teresa.Sitjar@transport.nsw.gov.au**Yass Zahab**



Geotechnical Services

 2 7589 2 7786 Yassine.El-Zahab@transport.nsw.gov.au**Richard Agostino**

C and CS

 2 0875 9 2137 Richard.Agostino@transport.nsw.gov.au**Human Resources****Robert Neloski**



Training — Learning and Development

 2 7567 robert.neloski@transport.nsw.gov.au**Peter Nilon**



Survey Group

 9848 9904 peter.nilon@transport.nsw.gov.au**Trainlink****Phillip Antonioli**

Operational Improvement Manager



 8574 2960 0417694249 Phillip.antonioli@transport.nsw.gov.au**Ashley Brandse**

Associate Director Operations North & Central



 4962 9820 ASHLEY.BRANDSE@transport.nsw.gov.au

Robert Blanch



Area Manager Hunter & Regional North

 43499210 0458261501 ROBERT.BLANCH@transport.nsw.gov.au**Netti Byrnes**



Area Manager Central Coast

 43499210 0458261501 Annette.Byrnes@transport.nsw.gov.au**Leisa Case**



Area Manager Central Intercity

  0429900371 Annette.Byrnes@transport.nsw.gov.au**Dwayne Purcell**

Area Manager Central Regional

 0428670580 DWAYNE.PURCELL@transport.nsw.gov.au**Michael Dorrian**

Area Manager South Coast

  0439743316 Michael.dorrian@transport.nsw.gov.au**Ian Modon**

Area Manager South Main

 0427016255

NOTES

NOTICE TO SUBSCRIBERS

The Weekly Notice is issued every Tuesday, and takes effect on the following Monday.

Those who require the Weekly Notice must ensure that they receive it and are aware of the changes that affect their work duties and responsibilities.

Director Network Standards, Systems & Quality**Sydney Trains**

Level 4, 36-46 George Street

Burwood NSW 2134

Tuesday, 19 September 2023