

Worksite Protection Planning Diagrams

Lidcombe to Bankstown Line - Lidcombe to Bankstown - S00 & M24

Stations Covered

LIDCOMBE	2
BERALA	5
REGENTS PARK	7
BIRRONG	10
YAGOONA	13
BANKSTOWN	16

Kilometrage References

16.465km	2
18.855km	5

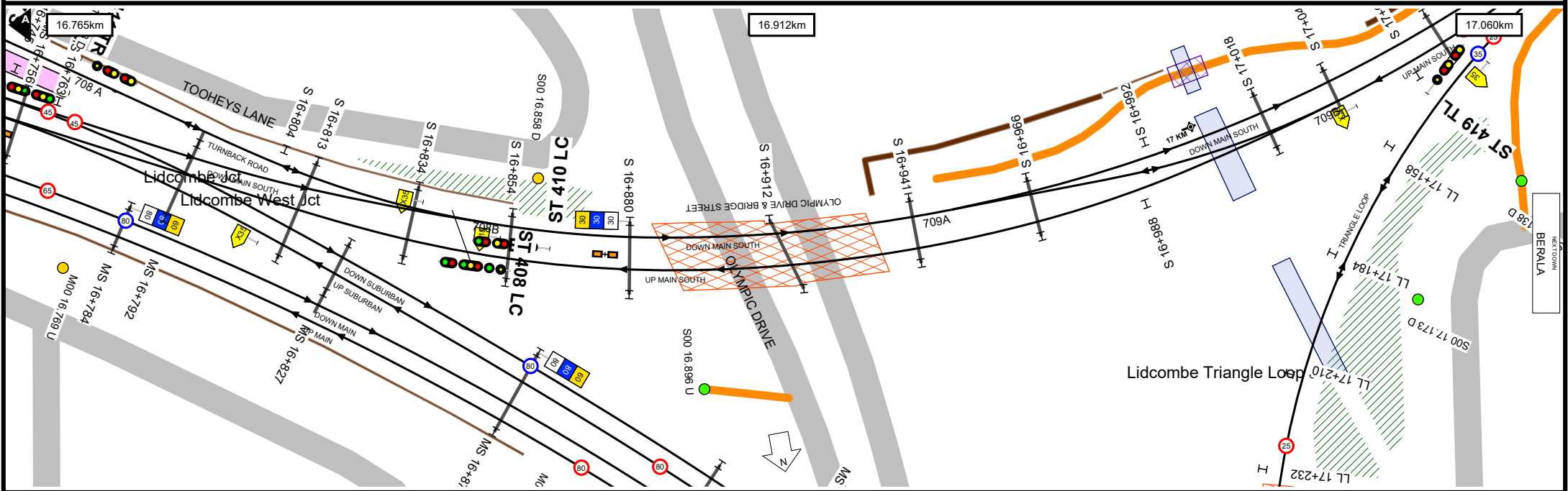
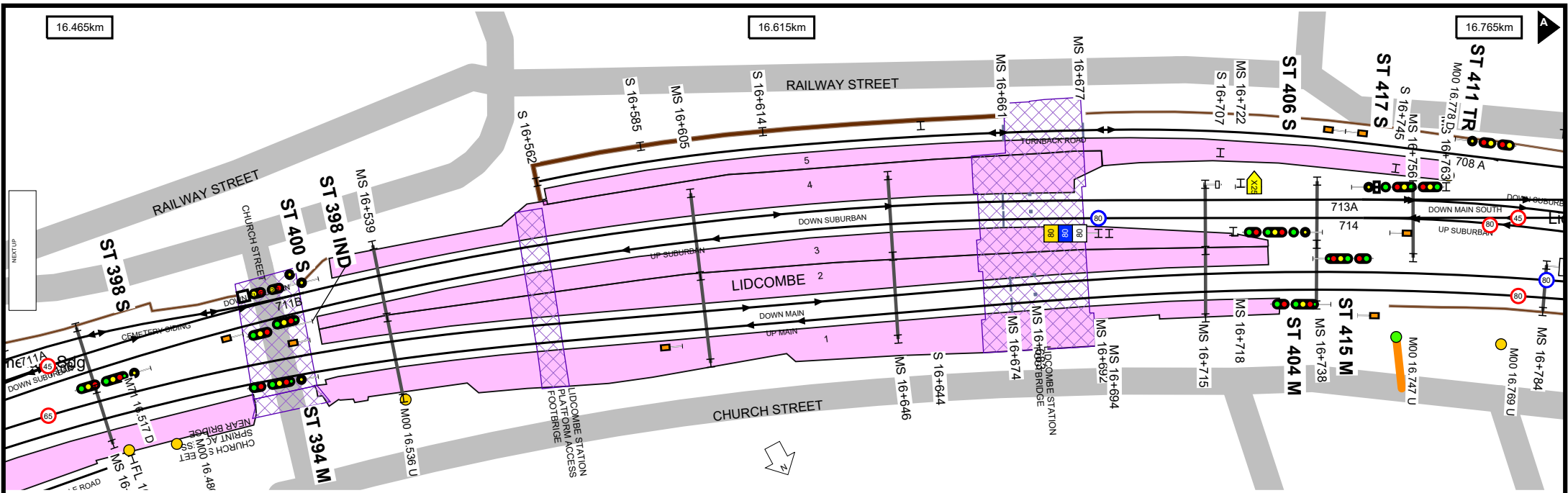

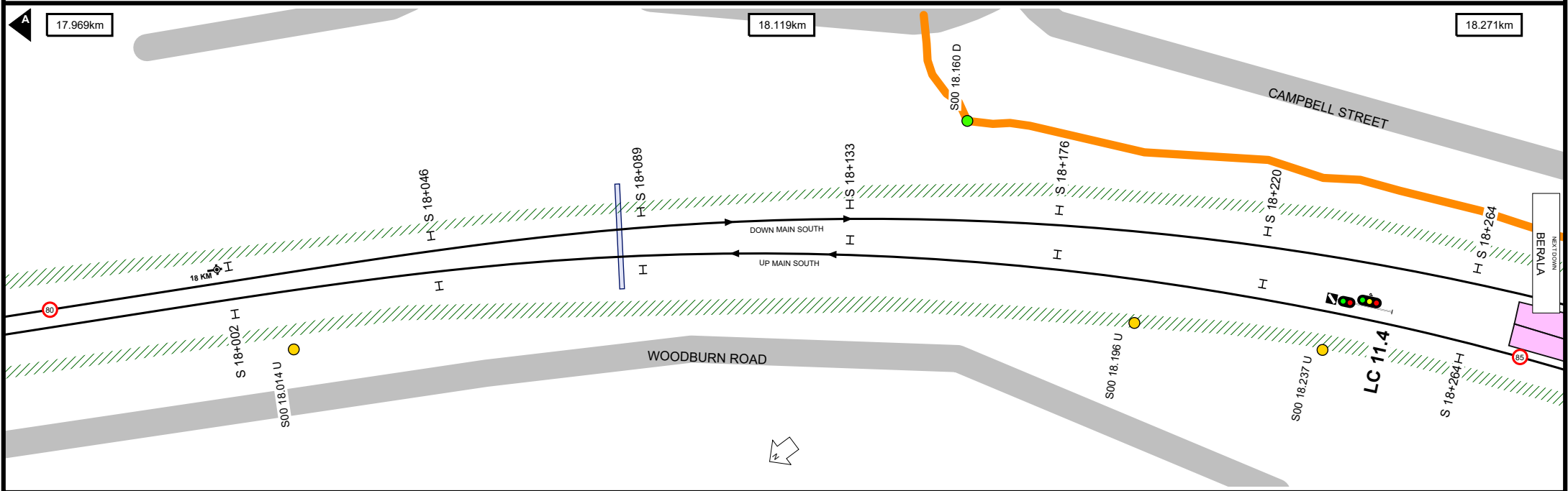

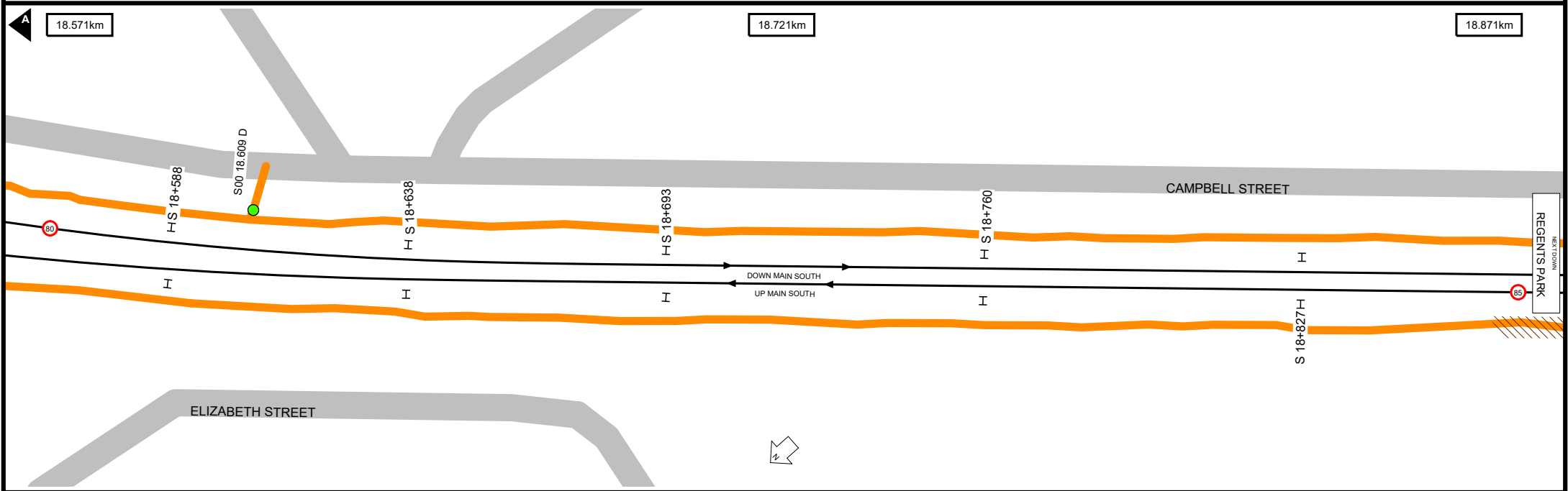
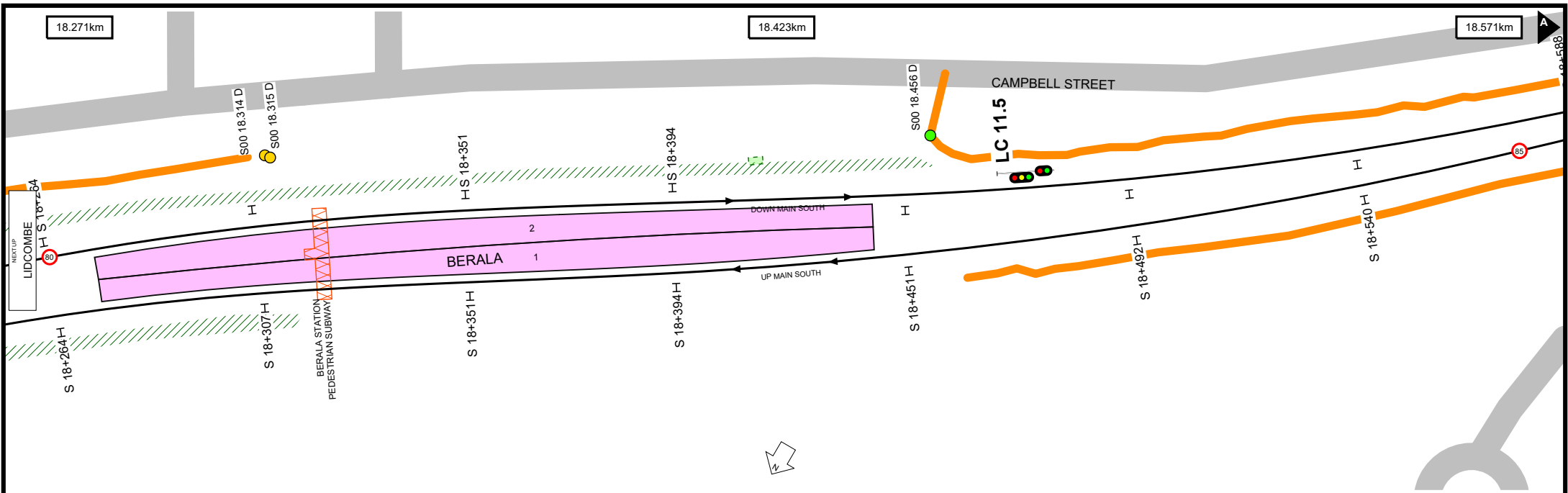

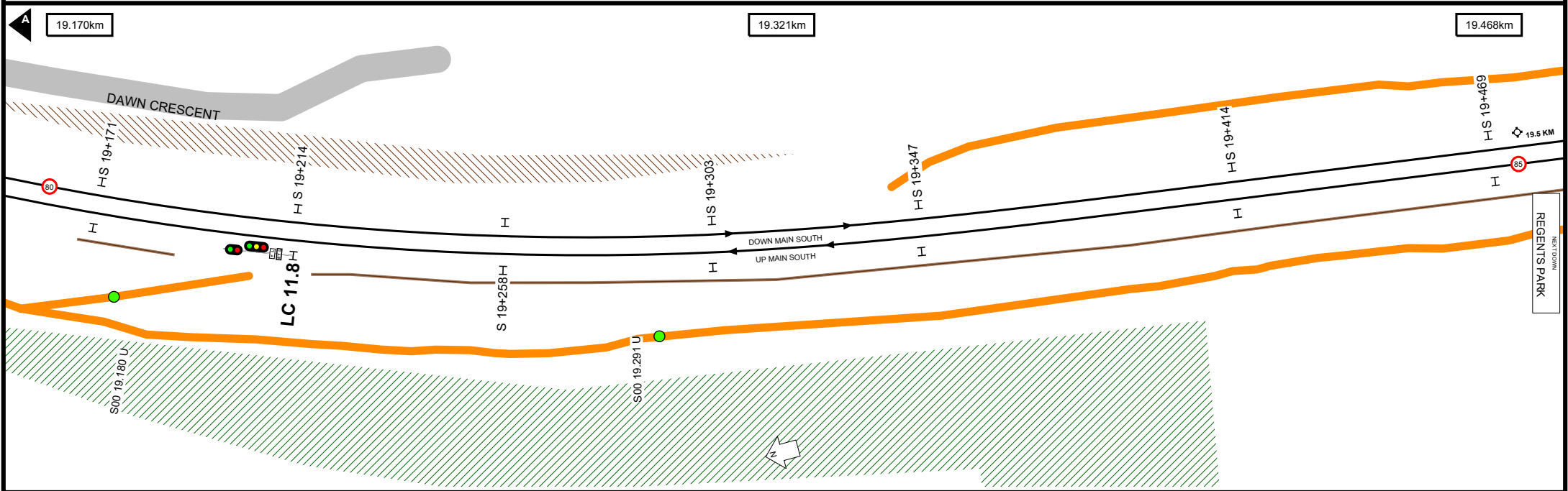
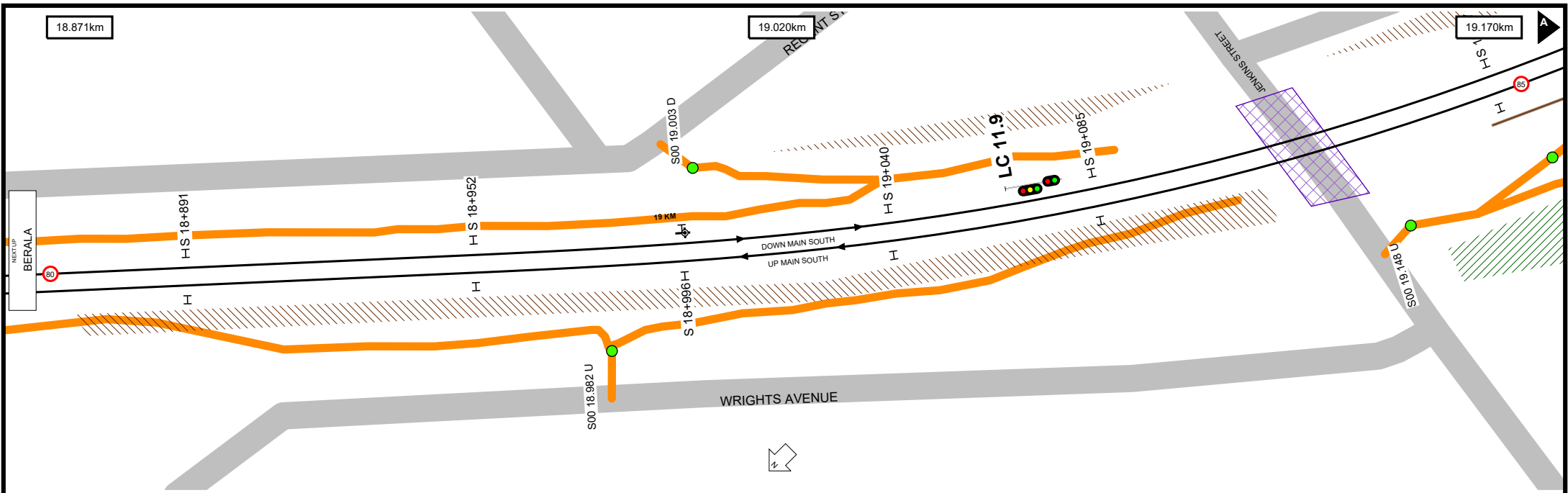

19.468km

19.619km

19.759km

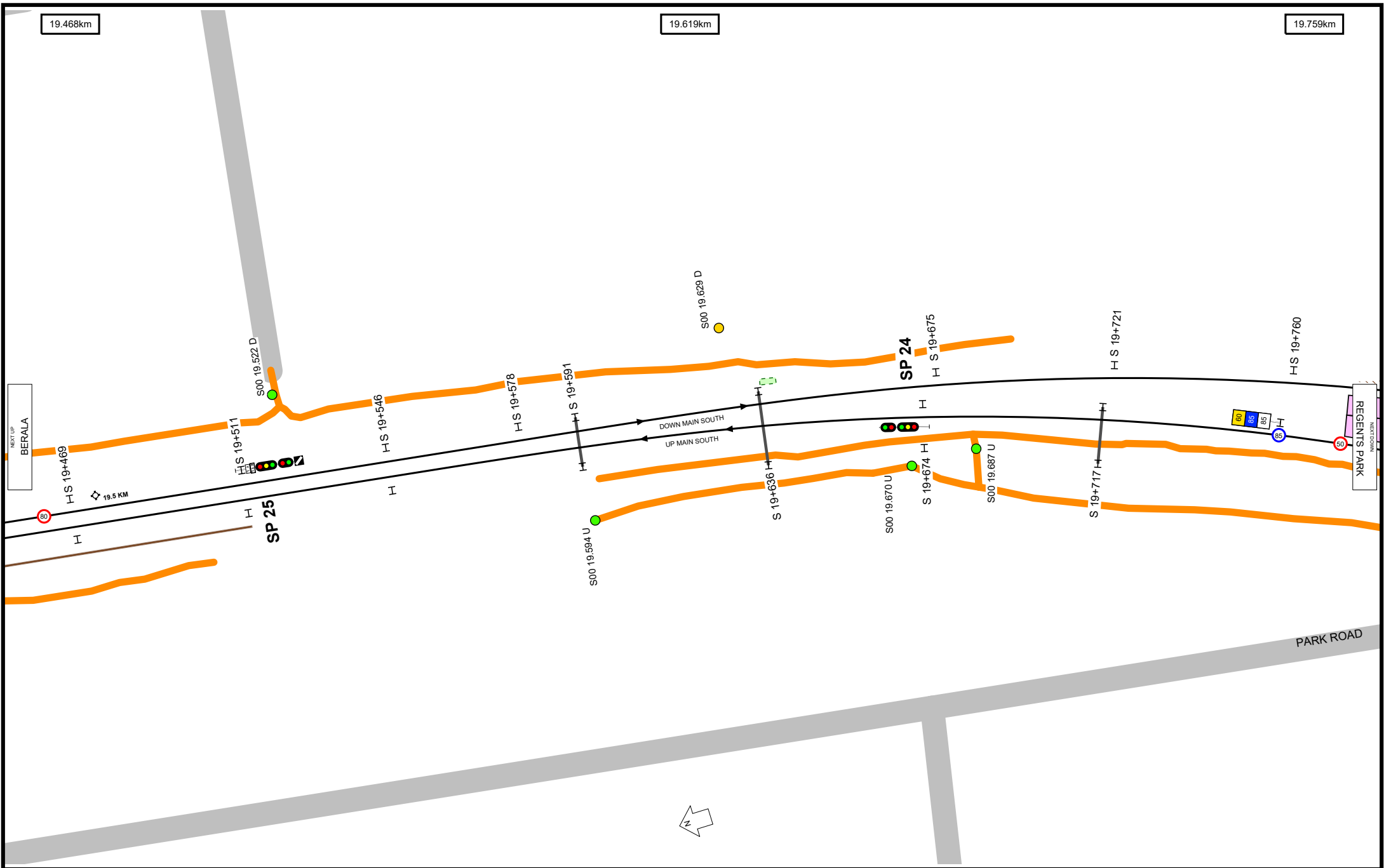

Worksite Protection Planning Diagram
 Contact: rcsp@transport.nsw.gov.au



Transport
for NSW

UNCONTROLLED WHEN PRINTED

Data shown here may not have been field verified.
 Do not use for operational purposes without checking against a controlled document.
 For data issues contact GIS.Support@transport.nsw.gov.au

TITLE: **Lidcombe - Bankstown**
 Page range 19.468-19.759km

A4
 03/02/2025



7

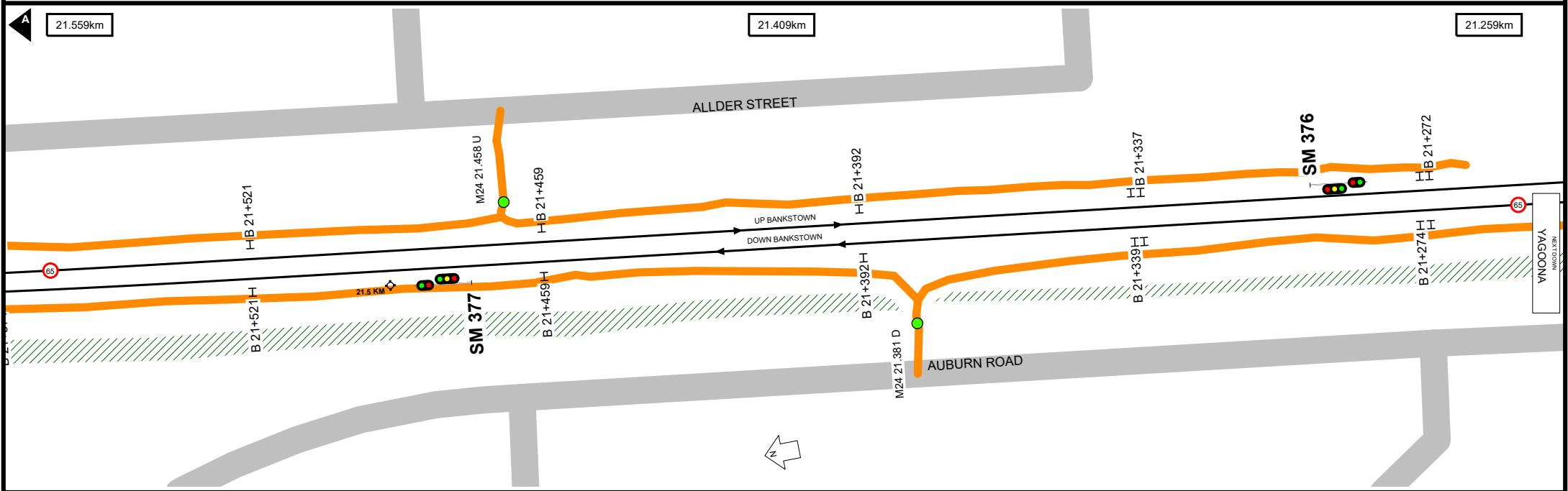
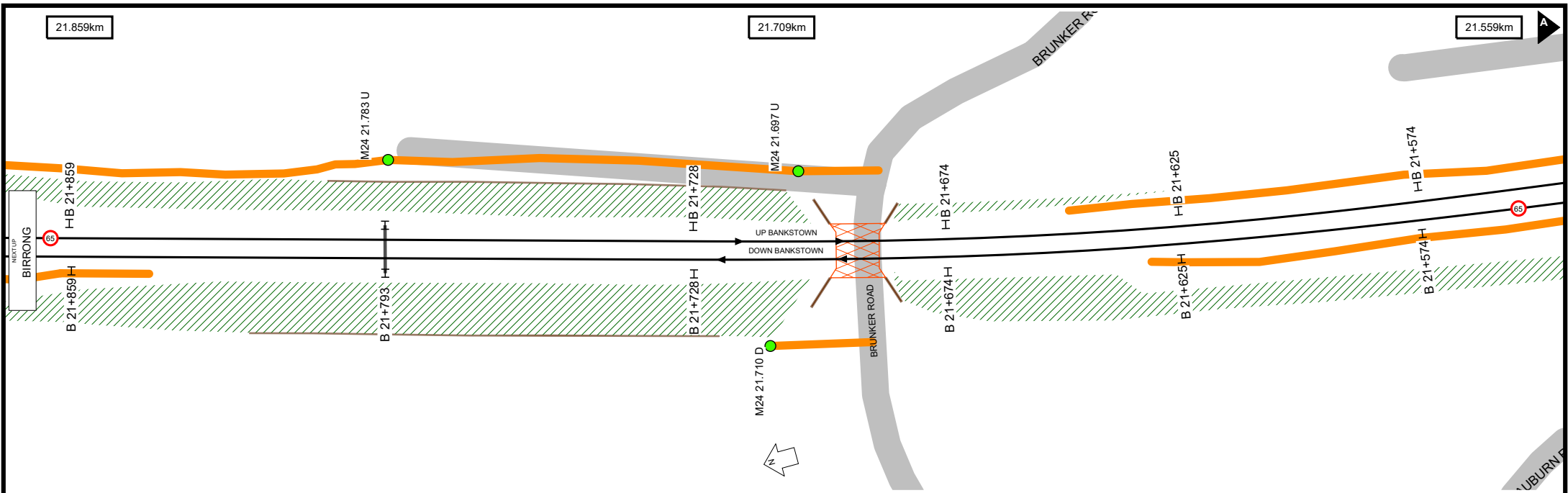

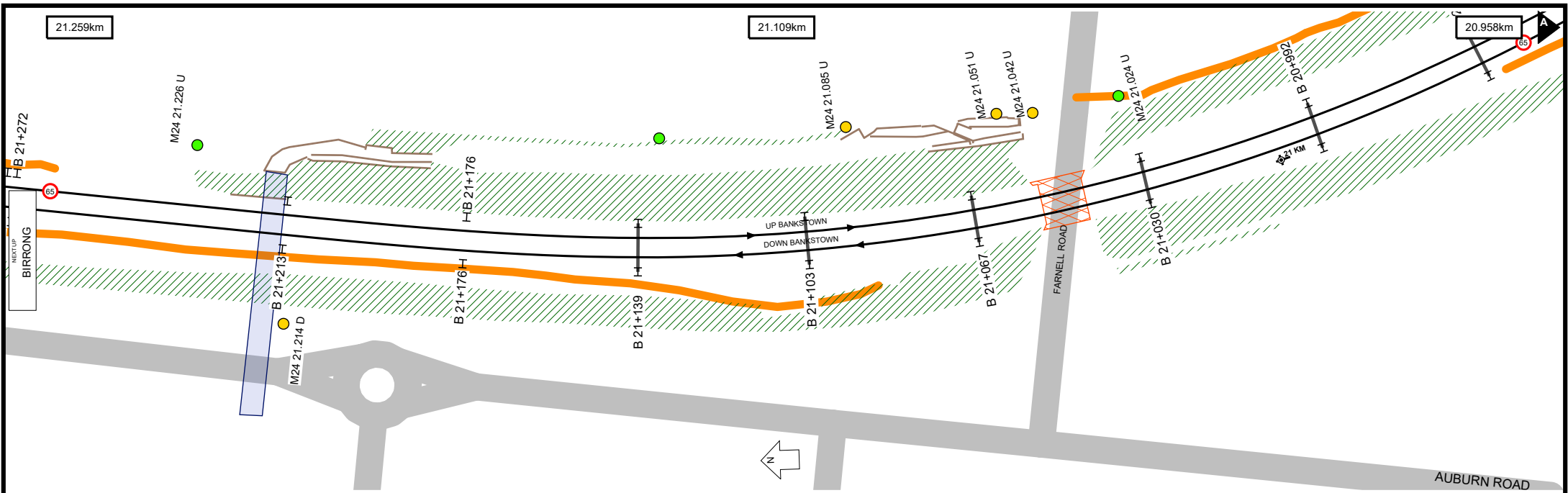

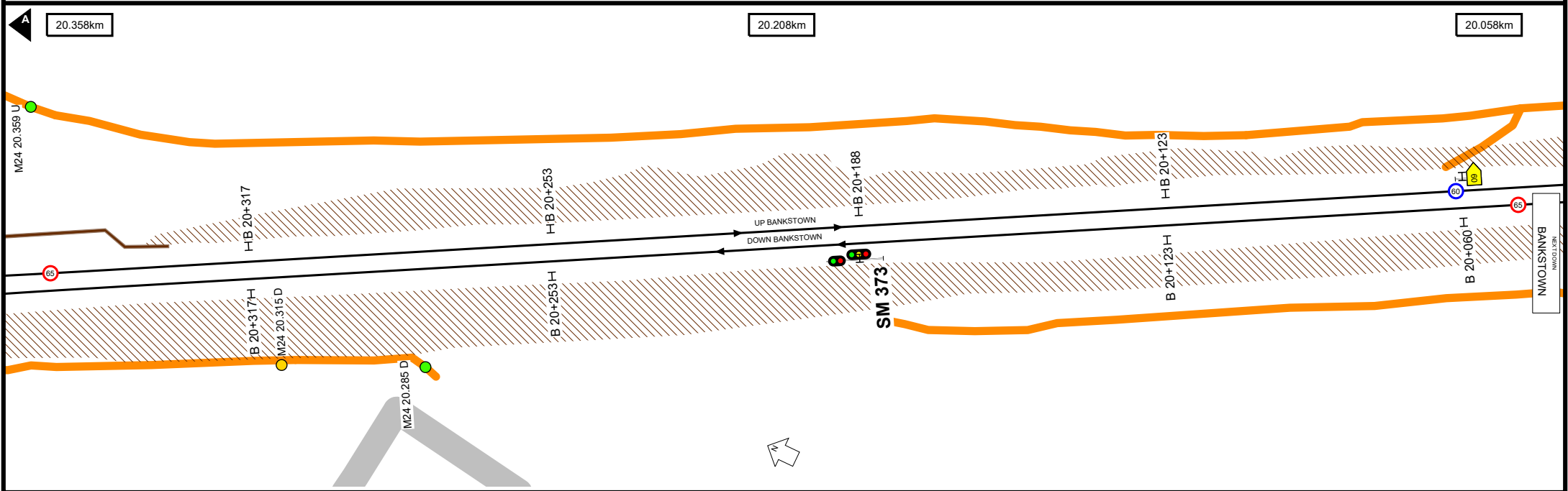
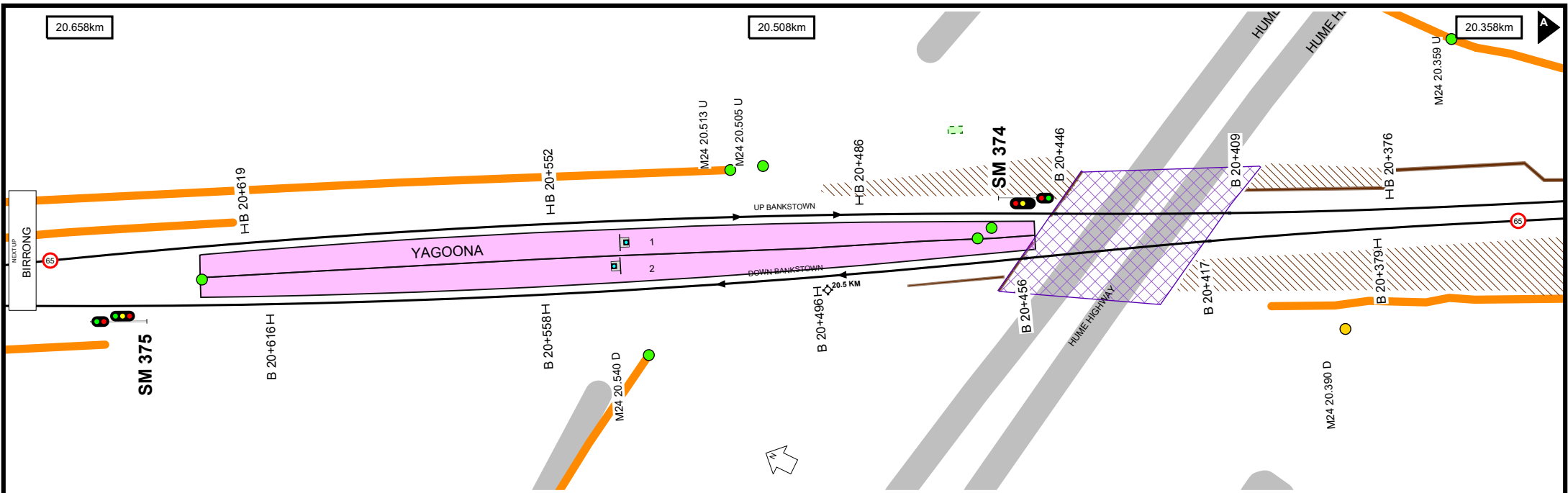

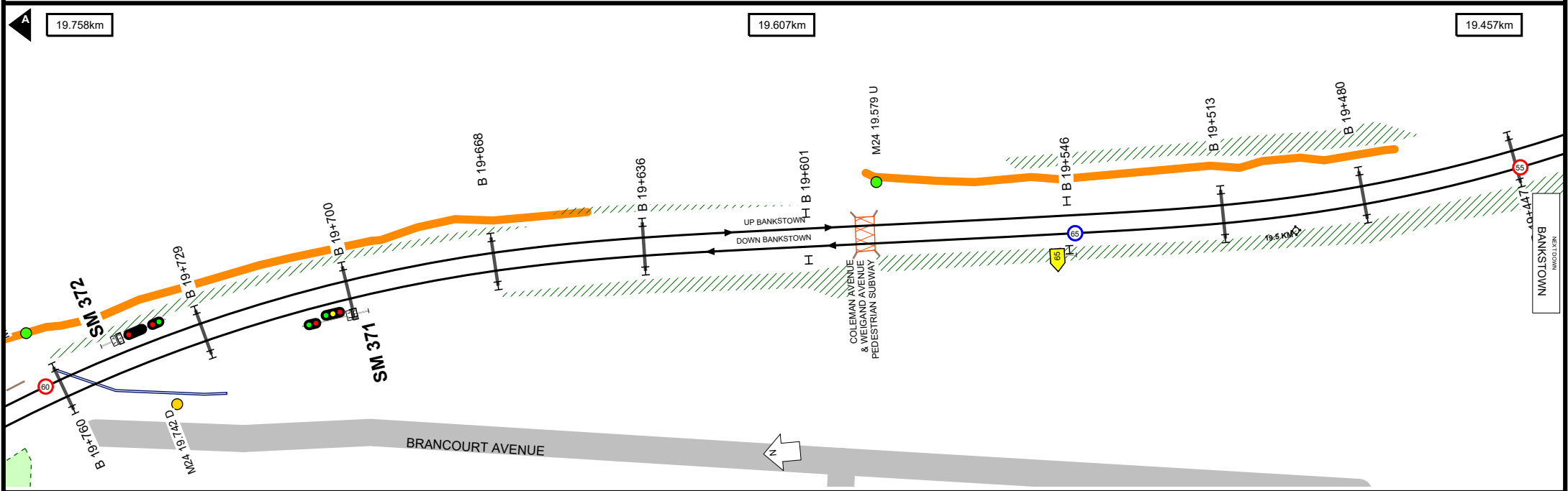
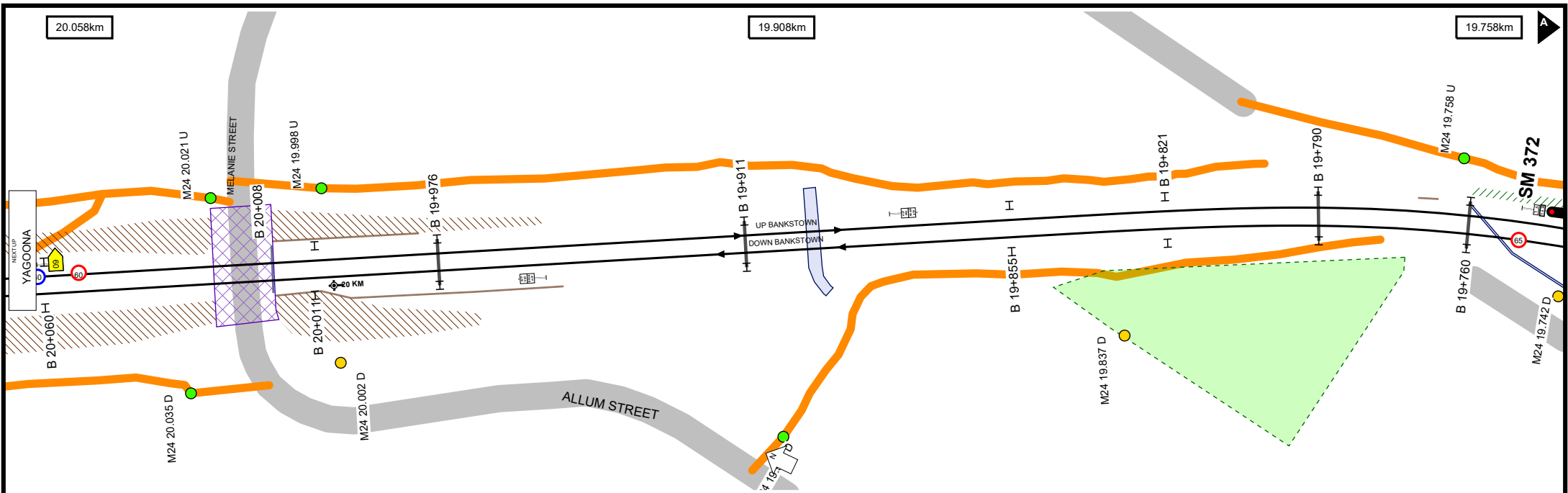

<p>Worksite Protection Planning Diagram Contact: rcsp@transport.nsw.gov.au</p>  <p>Transport for NSW</p>	<p style="color: red; font-weight: bold; font-size: 1.2em;">UNCONTROLLED WHEN PRINTED</p> <p><small>Data shown here may not have been field verified. Do not use for operational purposes without checking against a controlled document. For data issues contact GIS.Support@transport.nsw.gov.au</small></p>	<p>TITLE: Lidcombe to Bankstown Page range 19.758-19.758km</p> <p>SCALE: </p>	<p style="font-size: 1.5em; font-weight: bold;">A4</p> <p>03/02/2025</p> <p style="font-size: 1.5em; font-weight: bold;">14</p>
---	--	---	---

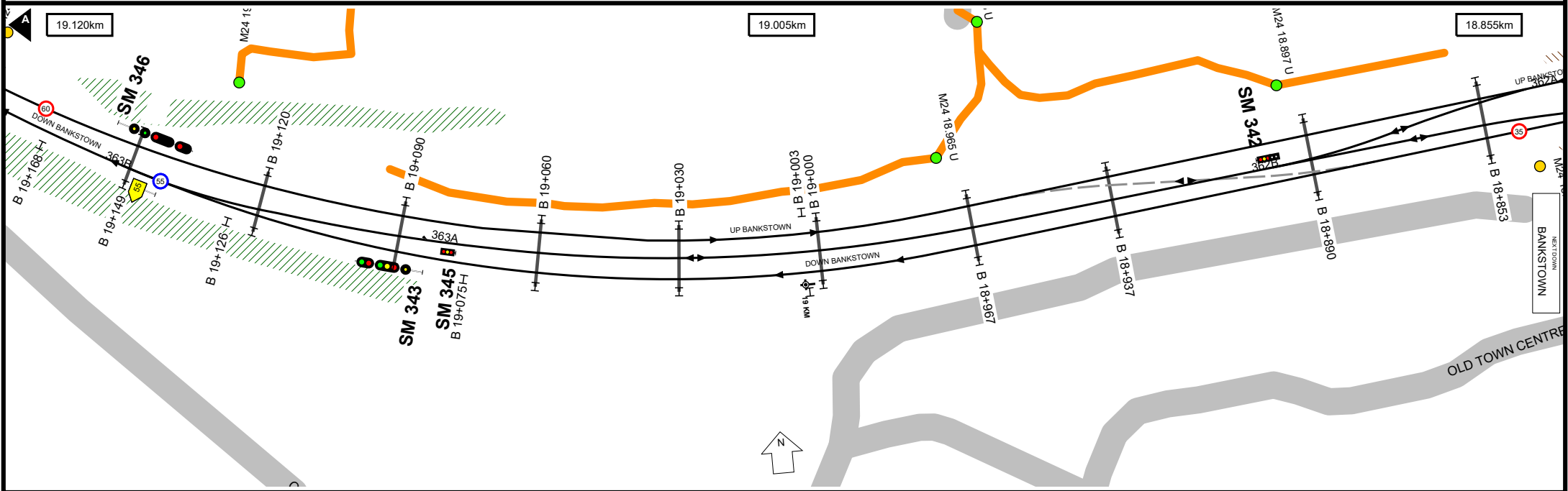
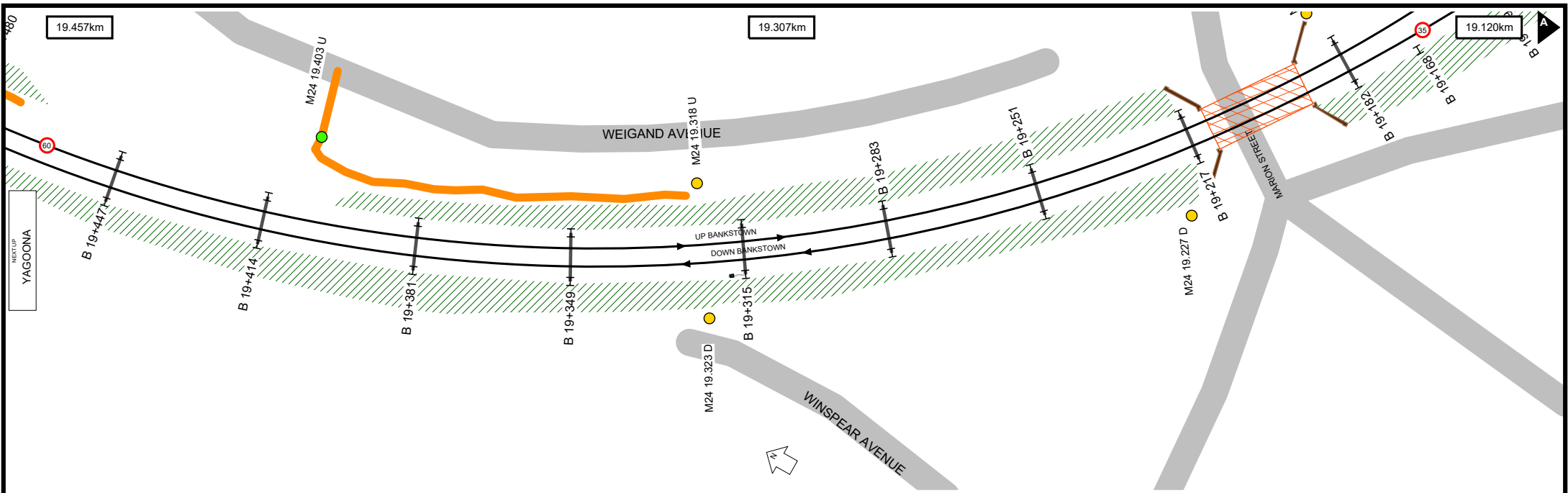

18.855km

18.705km

18.855km

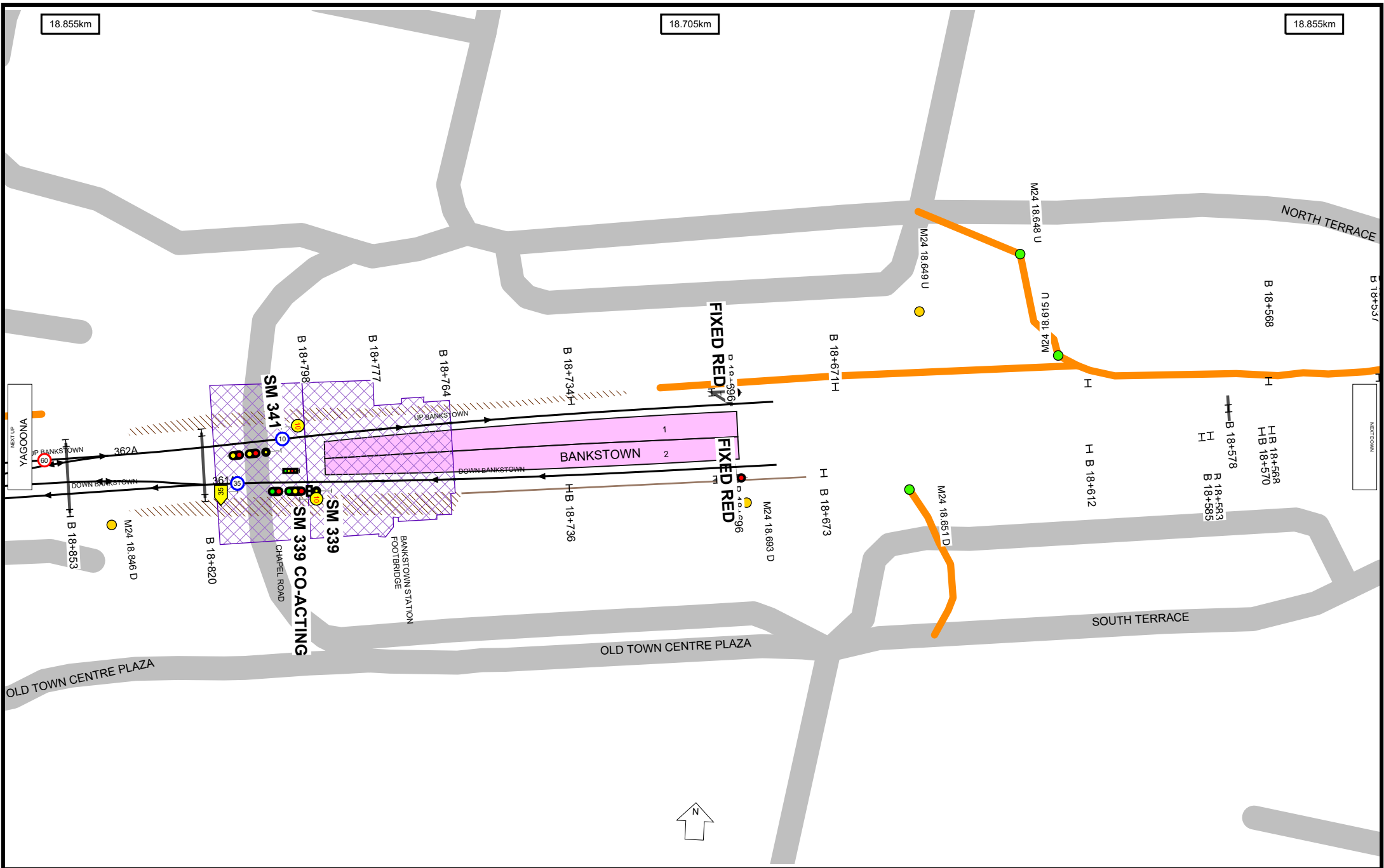

UNCONTROLLED WHEN PRINTED

Data shown here may not have been field verified.
 Do not use for operational purposes without checking against a controlled document.
 For data issues contact GIS.Support@transport.nsw.gov.au

Location Index

BANKSTOWN	16
BANKSTOWN SCTN HUT	16
BERALA	5
BIRRONG	10
LIDCOMBE	2
LIDCOMBE JCT	2
LIDCOMBE TRIANGLE LOOP JCT	2
LIDCOMBE WEST JCT	2
REGENTS PARK	8
SEFTON PARK EAST JCT	9
SEFTON PARK JCT	9
SEFTON PARK NORTH JCT	8
SEFTON SUB STN	8
SEFTON TRACTION SUBSTATION	8
YAGOONA	13
YAGOONA SCTN HUT	14
YAGOONA SUBSTATION	14
YAGOONA TRACTION SUBSTATION	14

Bridge Index

ACCESS ROAD	2	SEFTON TRIANGLE ACCESS BRIDGE	9
AMY STREET	8	VAUGHAN STREET	3
BANKSTOWN STATION FOOTBRIDGE	16	WATER PIPE FOOTBRIDGE	8
BERALA STATION PEDESTRIAN SUBWAY	5		
BRIDGE STREET	2		
BRUNKER ROAD	11		
CHAPEL ROAD	16		
CHURCH STREET	2		
CHURCH STREET SPRINT ACCESS NEAR BRIDGE	2		
COLEMAN AVENUE & WEIGAND AVENUE PEDESTRIAN SUBWAY	14		
FARNELL ROAD	12		
HUME HIGHWAY	13		
JENKINS STREET	6		
KERRS ROAD	4		
LIDCOMBE HASLAM'S CREEK	4		
LIDCOMBE STATION FOOTBRIDGE	2		
LIDCOMBE STATION PLATFORM ACCESS FOOTBRIDGE	2		
MARION STREET	15		
MELANIE STREET	14		
NEW BRIDGE LANDING	10		
OLYMPIC DRIVE	2		
OLYMPIC DRIVE & BRIDGE STREET	2		
REGENTS PARK CABLE BRIDGE	8		
REGENTS PARK SYDNEY WATER PIPE	8		
REGENTS PARK (M24) WATERWAY	8		
REGENTS PARK (S00) WATERWAY	8		
REGENTS PARK STATION FOOTBRIDGE	8		
RODD STREET	10		
SEFTON PARK JCT S00 DIVE	9		
SEFTON PARK JCT SSFL CABLE	9		
SEFTON PARK JCT SSFL WATERWAY	9		
SEFTON PARK JCT WATERWAY	9		